

We Bring People Together

Venue Guide

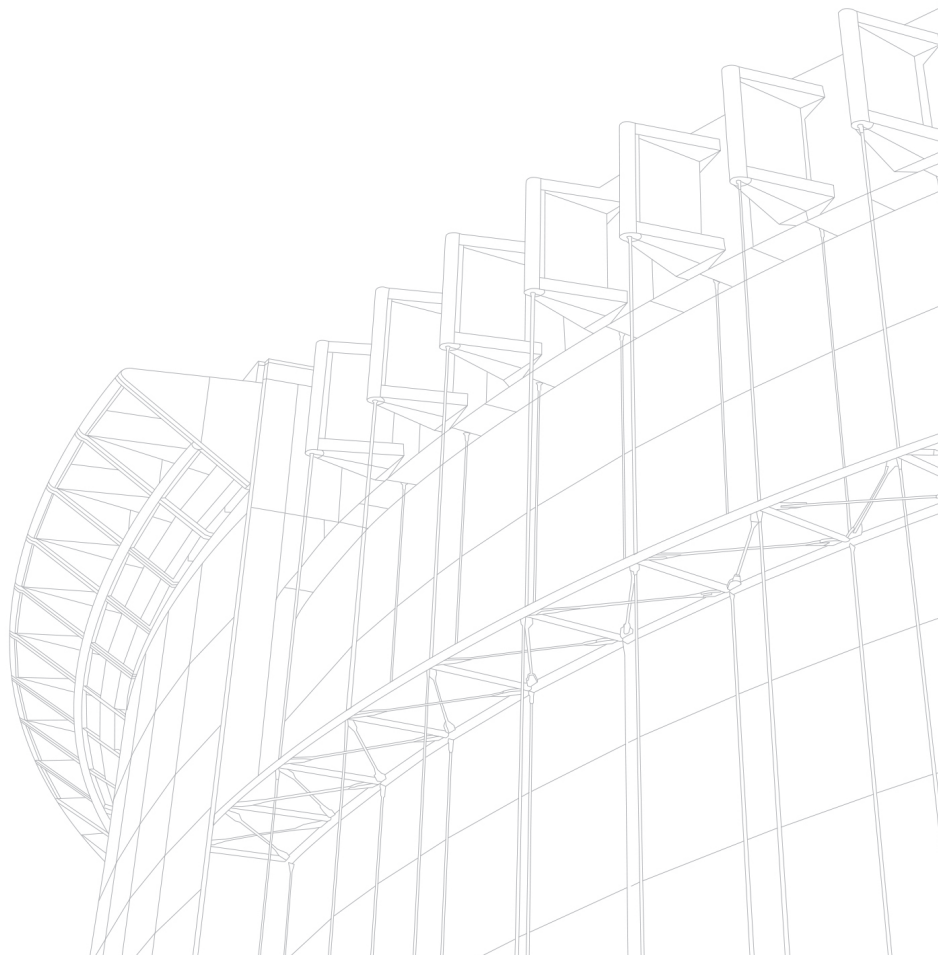



CONTENTS

About Coex	02
Coex Facilities & Amenities	04
Coex MICE Cluster	
Convention & Exhibition Halls	10
1st Floor	
- Grand Ballroom	12
2nd Floor	
- Conference Room North 201~211	14
- Coex Broadcast Studio(Studio159)	16
3rd Floor	
- Auditorium	18
- Conference Room E E1~E8	20
- Conference Room South 300~328	22
4th Floor	
- Conference Room South 400~403	26
Digital & Hybrid Venue	28
Xpace - Coex Digital Space	29
Exhibition Halls	
- HALL A	30
- HALL B	32
- HALL C	34
- HALL D	36
Capacity Summary	38

Contact Details

Coex, 513, Yeongdong-daero, Gangnam-gu, Seoul 06164, Korea
Telephone: +82 2 6000 1122, 1123
Facsimile: +82 2 6944 8374
Email: convention@coex.co.kr
Website: www.coexcenter.com

About Coex

Coex, a future-focused leader of the business events industry

Since opening in March of 1979, Coex has provided a global exchange platform where people and businesses come together through exhibitions and conferences. Located at the heart Seoul, we're proud to say that Coex has become a pillar of the Asian MICE market as both Korea's greatest exhibition venue and a tourist attraction with infrastructure to service all your business needs.

Today, Coex embraces digital transformation by equipping the venue with 10-gigabit internet, operating newly built "Coex Broadcast Studio(studio159)" and offering hybrid solutions, including live video streaming and online event platforms. Together with its dedicated team of professionals and cutting-edge facilities, Coex will deliver a seamless event experience for all types of in-person, virtual and hybrid events.

At Coex, the future awaits.

Fields of Business

Korea's premier convention and exhibition center

Coex is comprised of four stories with 36,007m² of exhibition space and a floor area of 460,000m². Our four exhibition halls can be partitioned into nine separate spaces and 100 meeting room spaces can accommodate larger meetings or banquets, or can be divided into smaller rooms for any type of functions. With over 30 years of accumulated building management system and the state-of-the-art equipment, our award-winning facility, Coex, is your preferred venue delivering extraordinary experiences for all types of events.

Venue management

With its expertise in venue management and active promotion of the exhibition industry, Coex has been trusted to foster multiple local and international exhibition centers over the years. Currently, Coex manages Coex Magok-Le West, the Changwon Exhibition and Convention Centre (CECO) in Gyeongnam province, and signed a contract with Vietnam's Becamex IDC to run the WorldTrade Centre Binh Duong New City Expo in Vietnam.

Exhibition planning and organizing

In 2002, Coex was the first Korean organization to obtain UFI certificate from the Global Association of the Exhibition Industry after demonstrating its ability to host world-class exhibitions. As the Korea's leading exhibition organizer, Coex annually organizes more than 30 exhibitions in Korea and abroad, including China, Indonesia and Vietnam.

Event management

As both a PCO and PEO, Coex provides a wide range of support services for a variety of events such as exhibitions, outdoor events, award ceremonies, and more. Coex also offers comprehensive support for international conferences including event planning, budget planning, operations, and more.

Affiliates and Alliances

Coex is a member of the following professional organizations :

Domestic

- AKEI (Association of Korean Exhibition Industries)
- KAPCO (Korea Association of PCO)
- KEOA (Korea Exhibition Organizers Association)
- KITA (Korea International Trade Association)
- KMA (Korea MICE Association)
- SMA (Seoul MICE Alliance)

International

- AFECA (Asian Federation of Exhibition & Convention Associations)
- AIPC (International Convention Center Association)
- IAPCO (International Association of Professional Congress Organizers)
- ICCA (International Congress & Convention Association)
- UFI (Union des Foires Internationales)
- WTCA (World Trade Center Association)



Events hosted by Coex

Coex's state-of-the-art infrastructure, spacious multi-functional meeting rooms and convenient location are pull factors for event organizers and participants, allowing Coex to attract many high-profile, large scale events to the center. Our portfolio includes but not limited to the following events :

- 2000 | ASEM (Asia-Europe Summit, 7,000 pax)
- 2002 | World Cup Media Center
- 2006 | Association of National Olympic Committees (ANOC) General Assembly (1,000 pax)
- 2007 | World Lung Cancer Congress (5,500 pax)
- 2010 | G20 Seoul Summit (15,000 pax)
- 2011 | World Congress on Dermatology (12,000 pax)
- 2012 | Seoul Nuclear Security Summit (10,000 pax)
- 2014 | Air Cargo Forum (5,000 pax)
- 2015 | World Allergy Congress (4,000 pax)
- 2016 | 94th General Session & Exhibition of the International Association of Dental Research (12,000 pax)
- 2017 | UIA World Congress of Architects and General Assembly (6,000 pax)
- 2018 | The 24th Int'l Union of Biochemistry and Molecular Biology Seoul Congress (6,000 pax)
- 2019 | International Bar Association Annual Conference (6,000 pax)
Google Cloud Summit (5,000 pax)
- 2020 | The 19th International Anti-Corruption Conference (7,400 pax)
- 2022 | World Forestry Congress (15,000 pax)



Coex-organized exhibitions

Coex is Korea's leading exhibition organizer and organizes more than 20 international annual trade shows, including 11 officially UFI-approved trade shows.

Domestic

- Smart Factory + Automation World
- Sourcing Fair
- Coffee Expo Seoul
- Energy Plus
- EVTREND KOREA
- Coex Food Week
- Food Industry Technology Show Korea

International

- VIETBABY
- Vietnam International Machinery Fair
- Vietnam International Retail + Franchise Show
- Vietnam International Premium Products Fair
- Jakarta International Premium Products Fair
- Interbattery Europe 2023

Coex Facilities & Amenities

The Coex Convention & Exhibition Center in Seoul is Korea's premier events venue, providing more than 30 years of experience and know-how in the domestic and international MICE industry. Coex is conveniently located in the heart of Seoul's business district with major 5-star hotels, a huge shopping mall, convenient transportation linkage, and an advanced IT infrastructure to ensure that all your needs are met right here under one roof.

Conference and Exhibition Venue

- Total Area 106,612m²
- 4 Exhibition halls (36,007m²)
- 51 meeting rooms
- studio159(294m²)

Hotels

- Grand InterContinental Seoul Parnas (550 rooms)
- InterContinental Seoul Coex (654 rooms)
- Oakwood Premier Coex Center (280 rooms)

Entertainment

- Seven Luck Casino
- Coex Aquarium
- Megabox Multiplex

Transportation

- City Airport Terminal
- Subway Line 2, Line 9

Shopping

- Starfield Coex Mall
- Hyundai Department Store
- Hyundai Duty-Free
- Parnas Mall

F&B

- Gramercy Banquet & Conventions
- [Devil's Door] American Style Gastropub
- No Brand Burger
- Viking's Wharf

**Experience Korea's
#1 events, dining,
and entertainment –
all under one roof.**

How to get to Coex

From Incheon International Airport

By Limousine Bus : Approximately 65-80 minutes (70km)

By Taxi : Approximately 60 minutes

By Subway : Approximately 100-110 minutes (Line 2 or Line 9)

From Gimpo Airport

By Limousine Bus : Approximately 45-55 minutes (35km)

By Taxi : Approximately 60 minutes

By Subway : Approximately 65 minutes (Line 9)

By Subway

Line no. 2 : Samseong Station Exit 5-6

Line no. 9 : Bongeunsa Station Exit 7

The City Airport Terminal

Coex City Airport Terminal(CALT) provides a convenient non-stop limousine bus services to and from the Incheon International Airport.

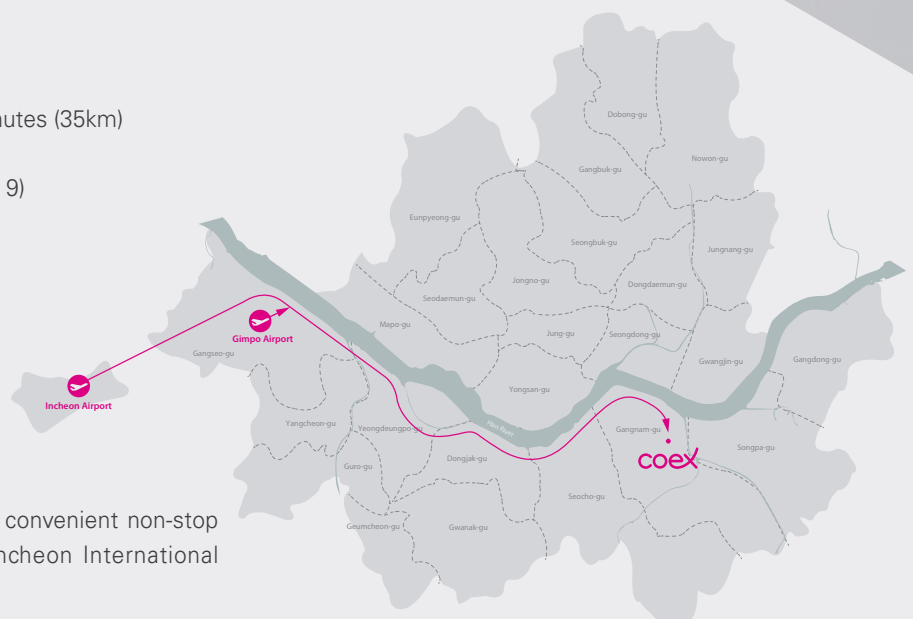

Coex MICE Cluster & Facilities

Coex is part of what is called 'Coex MICE Cluster (CMC)', which includes 16 of the World Trade Center site's entertainment, shopping, business, transportation, and accommodation services. CMC aims to maximize the potential of the entire Trade Center as a prime event venue, and through this collaboration, Coex can offer optimal services to domestic and global business travelers.

CMC members includes Coex, InterContinental Seoul COEX, Grand InterContinental Seoul Parnas, Seven Luck Casino, Starfield Coex Mall, Parnas Mall, Hyundai Department Store, Coex Aquarium, Megabox, Coex City Airport Terminal(CALT) and more.



**Korea's premier
MICE cluster combining
entertainment and
business**

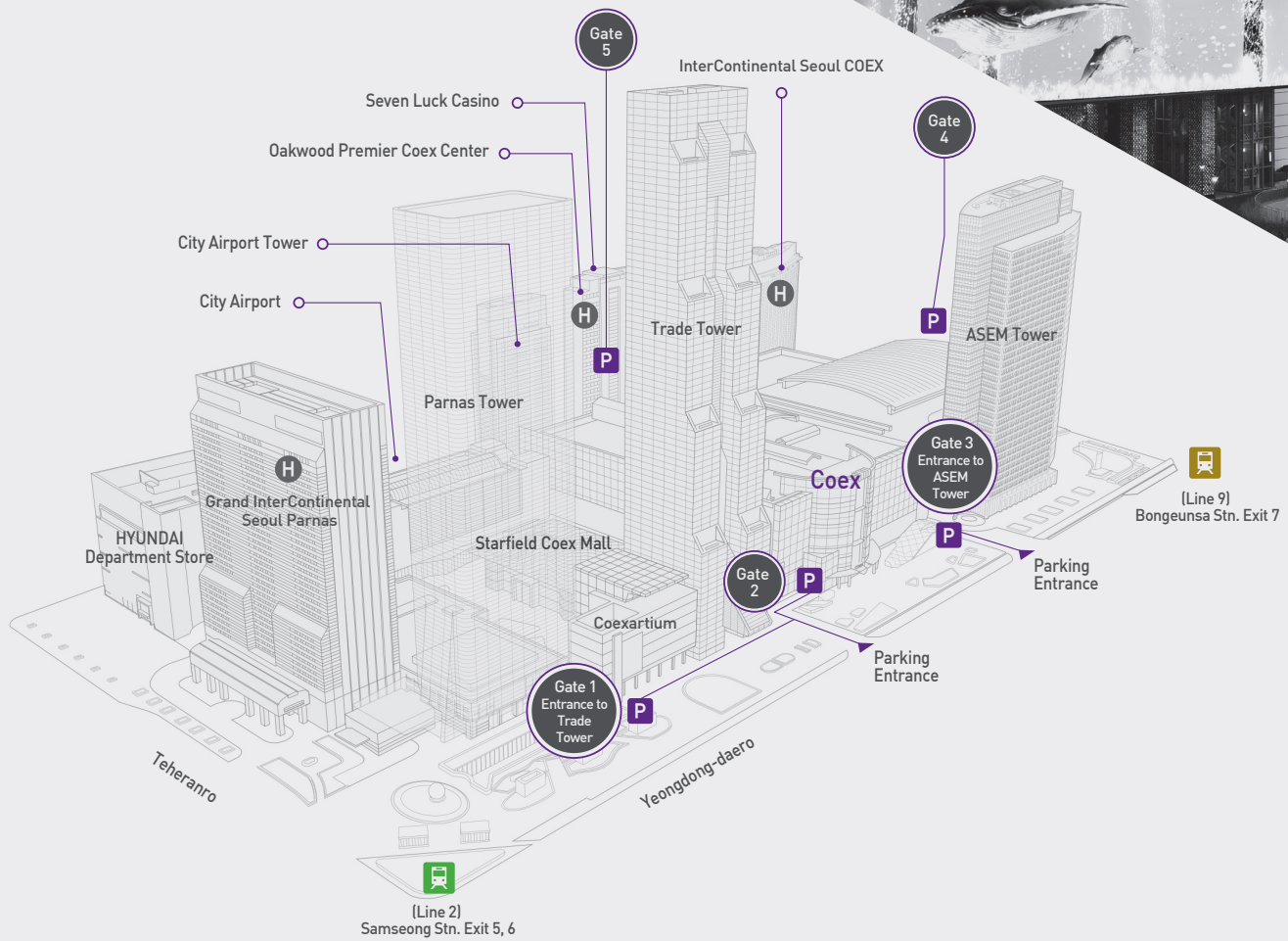

190,386 m²

A micro-city with an area of 190,386m²



47,621 m²

Featuring 47,621m² of convention space



19,780 people

A variety of 111 meeting spaces for up to 19,780 people



1,485 rooms

3 five-star hotels on-site with 1,485 guest rooms



110 times

110 Airport limousine buses travel daily between the World Trade Center Seoul and Incheon International Airport



1,000 people

Premium casino with a capacity of 1,000



13,578 people

181 different food & beverage options for up to 13,578 people



1,163 stores

Unlimited shopping from 1,163 stores



3,529 seats

Multiplex with 3,529 seats



20,000 Creatures

Aquarium with 20,000 under water creatures

Hotel Accommodations

Situated at the heart of Gangnam district, Coex is within walking distance of multiple transport links and more than 6600 hotel rooms. The accommodations below are all located within 5km distance.

★★★★★

01	Grand InterContinental Seoul Parnas	521, Teheran-ro, Gangnam-gu	www.grandcparnas.com	+82 2 559 7777
02	InterContinental Seoul COEX	524, Bongeunsa-ro, Gangnam-gu	www.iccoex.com	+82 2 3452 2500
03	Oakwood Premier Coex Center	46, Teheran-ro 87-gil, Gangnam-gu	www.oakwoodpremier.co.kr	+82 2 3466 7000
04	Le Méridien Seoul	120 Bongeunsa-ro, Gangnam-gu	www.lemeridienseoul.com	+82 2 3451 8000
05	Park Hyatt Seoul	606, Teheran-ro, Gangnam-gu	seoul.park.hyatt.com	+82 2 2016 1234
06	Lotte Hotel World	240, Olympic-ro, Songpa-gu	www.lottehotel.com/world	+82 2 419 7000
07	JW Marriott Seoul	176, Sinbanpo-ro, Seocho-gu	www.jw-marriott.co.kr	+82 2 6282 6262
08	Signiel Seoul	300, Olympic-ro, Songpa-gu	www.lottehotel.com/signielseoul	+82 2 3213 1000
09	Andaz Seoul Gangnam	854, Nonhyeon-ro, Gangnam-gu		+82 2 2193 1234
10	Shilla Stay Samsung	506, Yeongdong-daero, Gangnam-gu	www.shillastay.com/samsung	+82 2 2230 0700
11	Sofitel Ambassador Seoul Hotel & Serviced Residences	209 Jamsil-ro Songpa-gu Seoul 05552 Korea	www.sofitel-seoul.com/en	+82 2 2092 6046

★★★★

12	Imperial Palace Seoul	640, Eonju-ro, Gangnam-gu	www.imperialpalace.co.kr	+82 2 3440 8000
13	Glad Live Gangnam	223, Bongeunsa-ro, Gangnam-gu	www.gladlive-hotels.com	+82 2 6177 5000
14	Hotel Riviera	737, Yeongdong-daero, Gangnam-gu	www.hotelriviera.co.kr	+82 2 541 3111
15	Hotel Foreheal	117, Hakdong-ro, Gangnam-gu	www.foreheal.com	+82 2 511 8810
16	L7 Gangnam	415, Teheran-ro, Gangnam-gu	www.lottehotel.com/l7/gangnam	+82 2 2011 1007
17	Four Points by Sheraton Gangnam	203, Dosan-daero, Gangnam-gu	www.fourpointsseoulgangnam.co.kr	+82 2 2160 8900
18	Hotel Peyto Samseong	9, Teheran-ro 87-gil, Gangnam-gu	www.peytohotel.com	+82 2 6202 2000
19	Ramada Seoul	410, Bongeunsa-ro, Gangnam-gu	www.ramadaseoul.co.kr	+82 2 6936 8100
20	HOTEL in 9	618, Yeongdong-Daero, Gangnam-gu	www.hotelin9.com	+82 2 311 9000

★★★

21	Hotel Entra	508, Dosan-daero, Gangnam-gu	www.entrahotel.com	+82 2 500 1500
22	IBIS Styles Ambassador Gangnam	431, Samseong-ro, Gangnam-gu	ibisstyles.ambatelen.com/gangnam	+82 2 3454 1101
23	Hotel Sunshine	205, Dosan-daero, Gangnam-gu	www.hotelsunshine.co.kr	+82 2 548 8222
24	Coatel	11, Gangnam-daero 53-gil, Seocho-gu	www.coatel.co.kr	+82 2 6288 3333
25	Urban Place Gangnam	30, Hyoryeong-ro 77-gil, Seocho-gu	www.urbanplaces.co.kr	+82 2 3474 3399
26	Hotel Denim	66, Nonhyeon-ro, Gangnam-gu	hoteldenim.com	+82 2 2058 1000
27	Hotel URI&	96, Samseong-ro, Gangnam-gu	www.uri-nhotel.com	+82 2 500 2300

Residences

28	Hotel ArtnouveauSeocho	357, Seocho-daero, Seocho-gu	www.artnouveauseocho.com	+82 02 560 7101-3
29	Gangnam Artnouveau City Hotel	49, 74 gil, Seocho-daero, Seocho-gu	www.gnanhotel.com	+82 2 580 750
30	ETIS Residence	13, Teheran-ro 92-gil, Gangnam-gu	N/A	+82 2 539 9080
31	Blooming Serviced Residence Hotel	3-4, 28gil, Tehaeran-ro, Gangnam-gu	www.bloominghouse.co.kr	+82 070 7204 2500

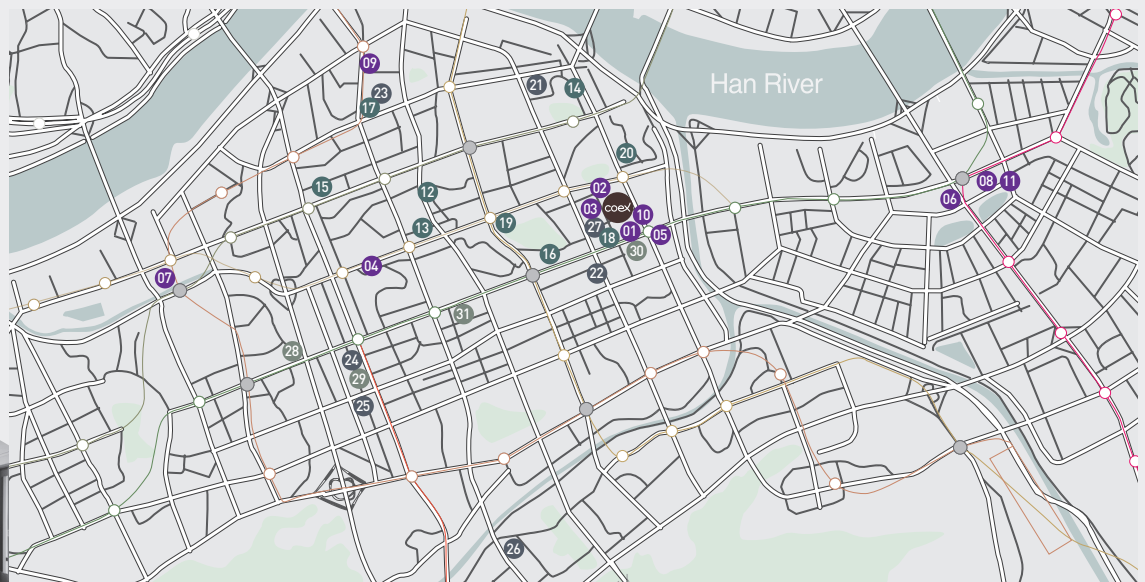

Shopping & Entertainment

Shopping Centers

In addition to our business facilities, Coex also offers a gateway to Korean culture, shopping and tourism.

Coex is connected to multiple shopping centers, including the largest underground shopping mall in Asia, Starfield Coex Mall, Parnas Mall, Hyundai Department Store allowing visitors to conveniently shop and dine.

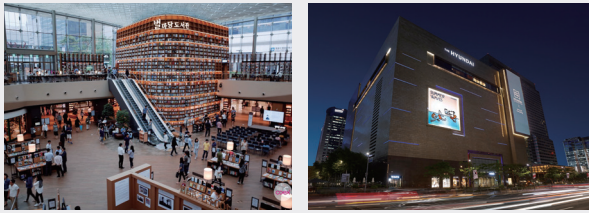

Seven Luck Casino

Seven Luck is a 3-story casino equipped with more than 200 table games and machines. The casino is open exclusively to international visitors and offers 5 VIP rooms with luxury service and privacy.

Coex Aquarium

The COEX Aquarium, a marine theme park in the city center, is an expedition space under the theme of "Fantastic Water Journey,". It is also a research facility, and a world-class tourist attraction with more than 1 million domestic and foreign visitors annually. By restoring the eco-friendly sea ecology, we are displaying more than 20,000 creatures of 400 species, and having unique content development through the harmony of nature, environment, and people to present you 365 days full of the joy.

Megabox

Located inside of Starfield Coex Mall, Megabox is one of Korea's largest multiplexes and offers private box and premium stalls such as THE BOUTIQUE, MX, COMFORT and DOLBY CINEMA.



Convention & Exhibition Halls

4F

Conference Room (South) 4F
400-403

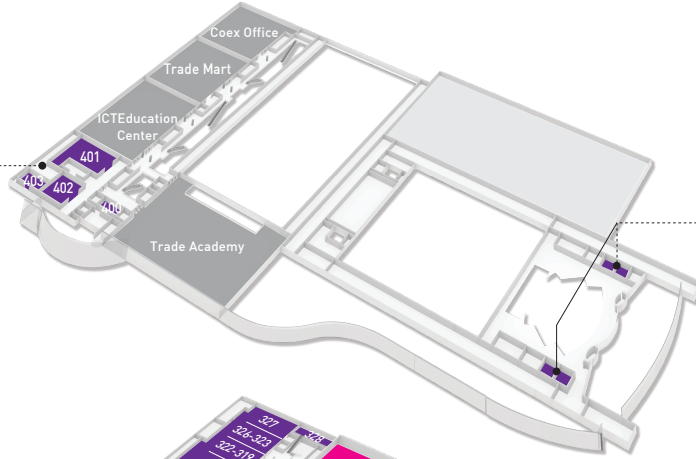

Auditorium Meeting Room 4F

3F

Conference Room (South) 3F
300-328

Hall C

Conference Room E (Hall E)

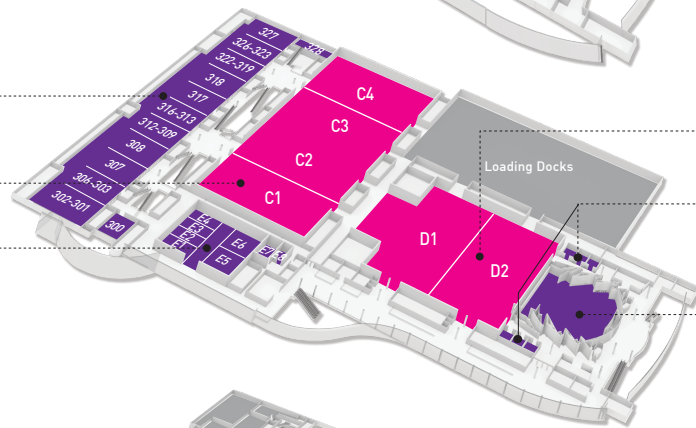

Hall D

Auditorium Meeting Room 3F

Auditorium

2F

Coex Broadcast Studio
(studio159)

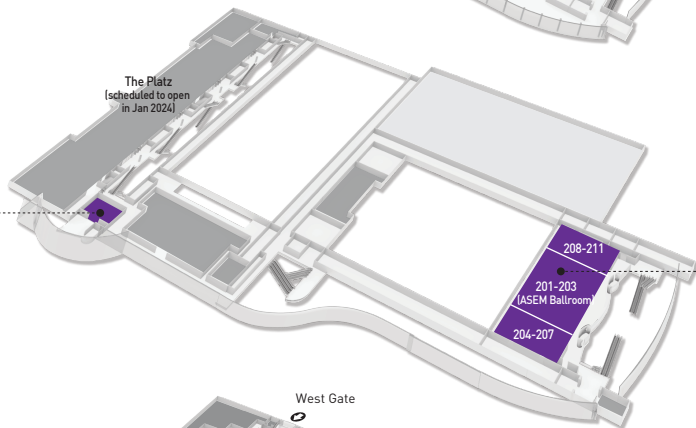

Conference Room (North)
201-211

1F

Hall A

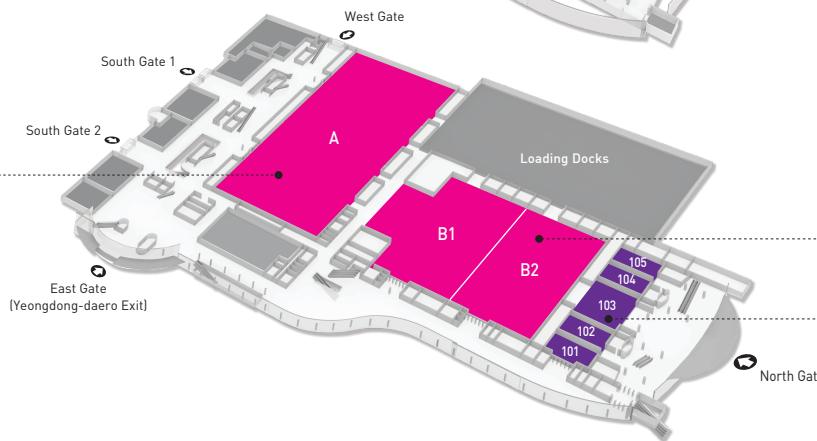

Hall B

Grand Ballroom



Venue Details

1F

- GRAND BALLROOM

2F

- ASEM BALLROOM / CONFERENCE ROOM (NORTH)
- COEX BROADCAST STUDIO (studio159)

3F

- AUDITORIUM
- CONFERENCE ROOM E (HALL E)
- CONFERENCE ROOM (SOUTH)

4F

- CONFERENCE ROOM (SOUTH)

DIGITAL & HYBRID VENUE

Xpace - Coex Digital Space

EXHIBITION HALLS

- HALL A
- HALL B
- HALL C
- HALL D

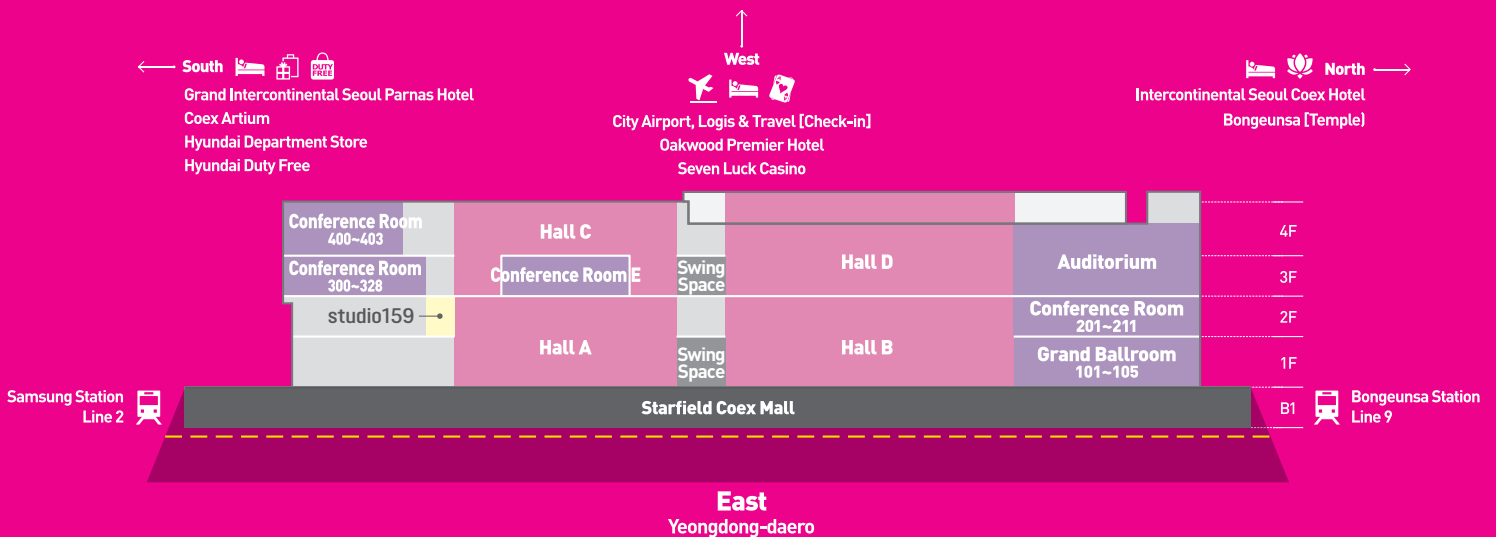

GRAND BALLROOM

Ideal Space for Your Special Event

Located on the first floor, the Grand Ballroom is a popular venue and ideal for exhibitions, conferences, corporate dinners, plenary sessions and other special events. Featuring 1,817m² of column-free space, which can be divided into sections with floor-to-ceiling partition walls, the Grand Ballroom is capable of holding five fully separated, self-sufficient, concurrent events simultaneously and can be tailored for all types of events. The multi-purpose rooms located near the main entrance are used as an organizer's office or VIP rooms, and major facilities include a control room, interpreter booths, retractable ceiling screens, a state-of-the-art A/V and lighting system to accommodate all types of events. Another advantage of the Grand Ballroom is its close proximity to the luxurious 5-star hotel, InterContinental Seoul COEX, allowing easy and convenient access for international visitors.

Venue	Dimensions		Area		Capacity		
	W x L x H (m)	W x L x H (ft)	m ²	ft ²	CL	TH	BQ
101	13x22.3x4.5	42.7x73.2x14.8	299	3,218	150	288	150
102	13x22.3x4.5	42.7x73.2x14.8	299	3,218	150	288	150
103	26.9x22.3x4.5	88.3x73.2x14.8	621	6,684	300	600	280
104	13x22.3x4.5	42.7x73.2x14.8	299	3,218	150	288	150
105	12.9x22.3x4.5	42.3x73.2x14.8	299	3,218	150	288	150
101-105	79x22.3x4.5	259.2x73.2x14.8	1,817	19,558	900	1,800	900

Location

1F

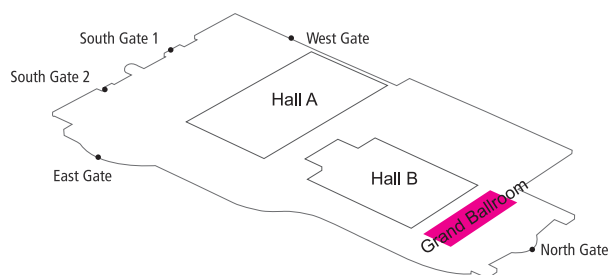

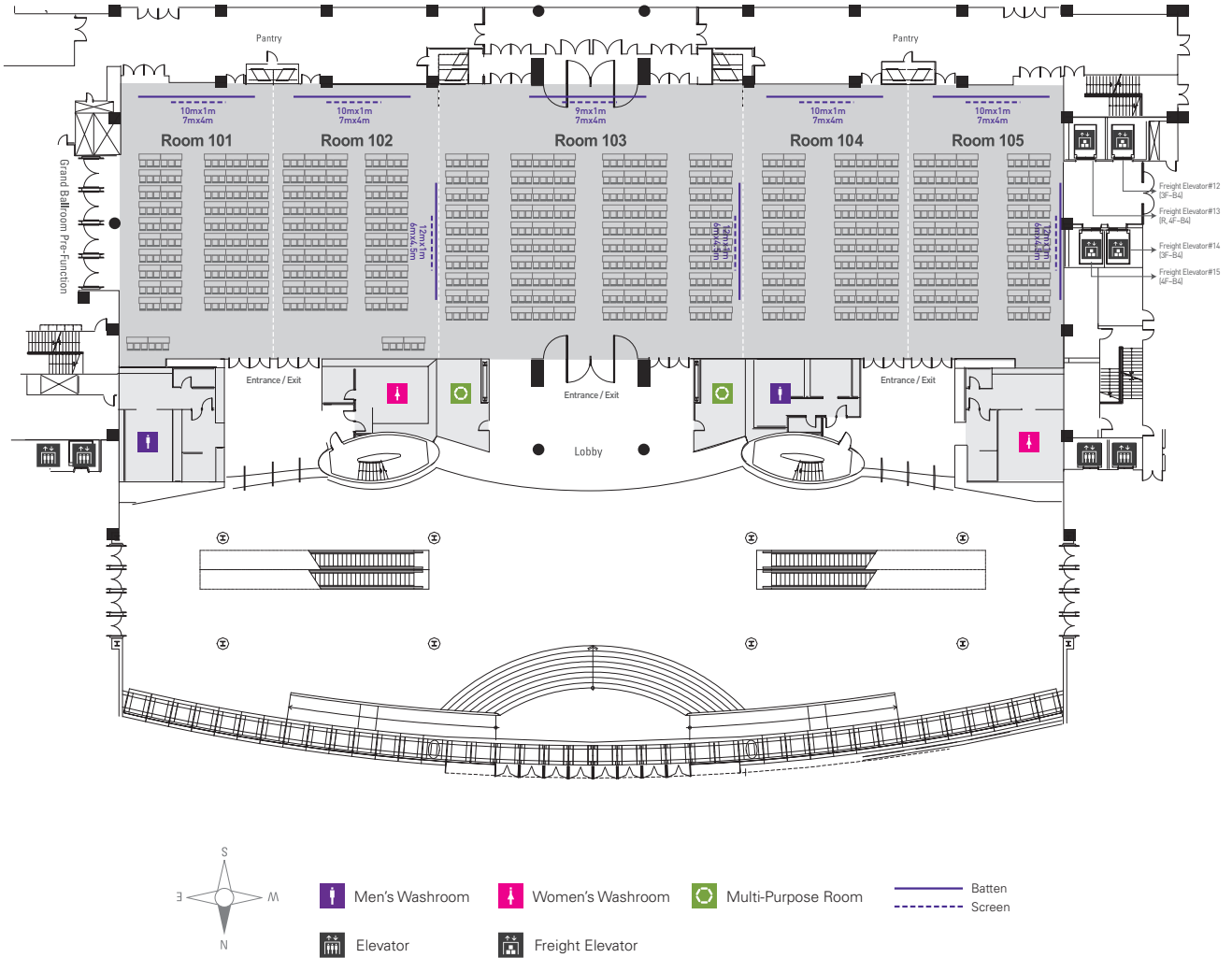

Details

Location	- 1st floor	Main Facilities	- A/V and lighting system - Retractable ceiling screens : 7m x 4m (300"), 6m x 4.5m (300") - 8 batten bars for banner (Sizes : 9m, 10m, 12m)
Floor Space	- 1,817m ² (Column-free space) - Partitioned floor place with moveable walls (5 sections)	Other Features	- 2 Multipurpose rooms (each size : 21m ²) *Can be used as coat rooms or VIP waiting rooms - Pre-function / foyer - 4 DID signage in foyer: 65" monitors (1,920 x 1,080 pixels)
Use	- Exhibitions, conferences, corporate dinners, plenary sessions and other special events.		
Capacity	- 1,800 people - 80 Exhibition booths (3m x 2m)		

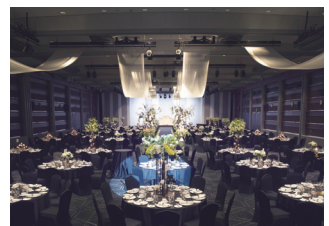
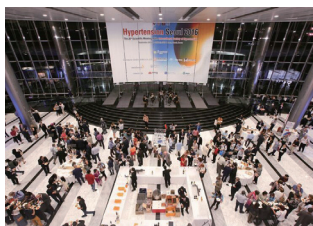
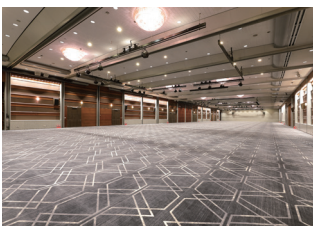



ASEM BALLROOM / CONFERENCE ROOM (NORTH)

Located on the second floor, the Conference Room North features a symmetrical floor plan with the ASEM Ballroom as the focal axis point. The ASEM Ballroom (Rooms 201, 202 & 203 combined) was given its name in 2018 during the renovation to commemorate the 3rd ASEM Summit that took place at this very spot in 2000. Offering up to a 900 capacity in a theater-style seating plan, the ASEM Ballroom is suitable to host large-scale events, especially when used in accompaniment with the Grand Ballroom on the first floor. The eight small to medium-sized rooms (Rooms 204~211) can be used to host individual seminars and workshops and/or as an auxiliary space such as organizer's offices and speaker waiting rooms.

Venue	Dimensions		Area		Capacity		
	W x L x H (m)	W x L x H (ft)	m ²	ft ²	CL	TH	BQ
201	14.5x23x3.7	47.6x75.5x12.1	341	3,670	180	360	150
202	15.2x23x3.7	49.9x75.5x12.1	341	3,670	180	360	150
203	14.5x23x3.7	47.6x75.5x12.1	341	3,670	180	360	150
201-203 (ASEM Ballroom)	44.2x23x3.7	145x75.5x12.1	1,023	11,011	540	918	360
204	9.9x2.8x2.9	32.5x9.2x9.5	28	301	12	24	-
205A	11x7x2.9	36.1x23x9.5	77	829	45	90	30
205B	11x7x2.9	36.1x23x9.5	77	829	45	90	30
205	11x14x2.9	72.2x23x9.5	154	1,658	84	160	80
206A	4.7x6.8x2.9	15.4x22.3x9.5	32	344	18	36	10
206B	4.7x6.8x2.9	15.4x22.3x9.5	32	344	18	25	-
206	9.4x6.8x2.9	30.8x22.3x9.5	64	689	36	60	30
207	4.4x6.8x2.9	14.4x22.3x9.5	32	344	18	36	10
208	9.9x2.8x2.9	32.5x9.2x9.5	28	301	12	24	-
209A	11x7x2.9	36.1x23x9.5	77	829	45	90	30
209B	11x7x2.9	36.1x23x9.5	77	829	45	90	30
209	11x14x2.9	72.2x23x9.5	154	1,658	84	160	80
210A	4.7x6.8x2.9	15.4x22.3x9.5	32	344	18	36	10
210B	4.7x6.8x2.9	15.4x22.3x9.5	32	344	18	25	-
210	9.4x6.8x2.9	30.8x22.3x9.5	64	689	36	60	30
211	4.4x6.8x2.9	14.4x22.3x9.5	32	344	18	36	10

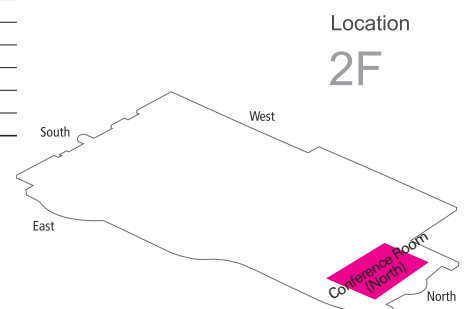

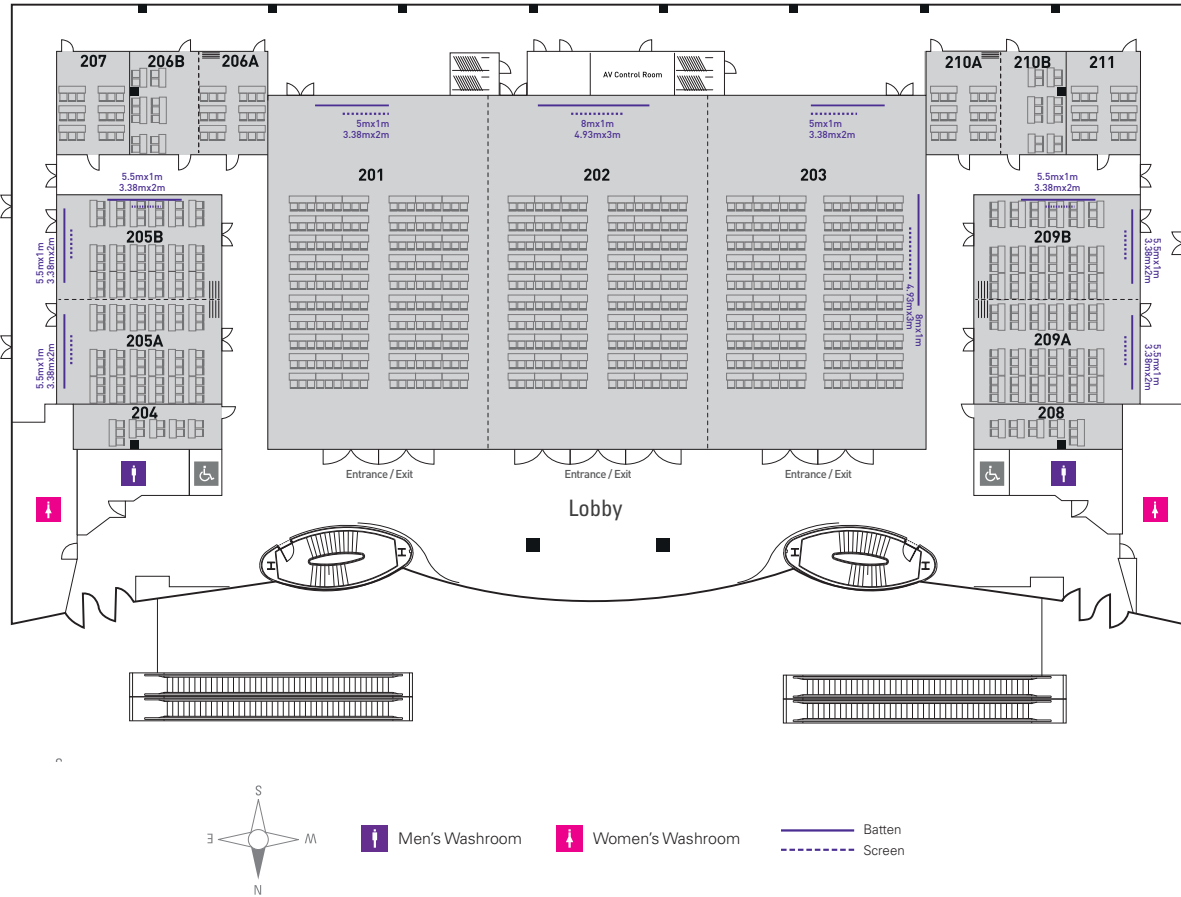

Details

	201~203 (ASEM Ballroom)	204~211
Location	- 2nd floor	- 2nd floor
Floor Space	- 341m ² per room (total 1.023m ²) - Partitioned floor place with moveable walls (3 sections)	- [204, 208] 28m ² per room - [205, 209] 154m ² per room (77m ² if divided into A and B) - [206, 210] 64m ² per room (32m ² if divided into A and B) - [207, 211] 32m ² per room - Partitioned floor place with moveable walls (12 sections)
Use	- Int'l conferences, banquets, corporate dinner	- Workshops, seminars, executive offices, waiting rooms, etc.
Main Facilities	- A/V system and a separate control room - Ceiling-mounted projector - Retractable ceiling screen : 150", 3.38m x 2m (201, 203) 200", 4.93m x 3m (202, 203) - Noise resistant partition walls - 4 batten bar for banner - DID Signage : 49" (1,080 x 1,920 pixels)	Use - [Rooms 205, 209] - A/V system - Ceiling-mounted projector - Retractable screen : 150", 3.38m x 2m - DID Signage : 32" (1,080 x 1,920 pixels)
Other Features	- Pre-function / foyer areas	

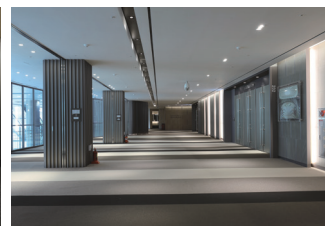

COEX BROADCAST STUDIO (studio159)



studio159

Coex Broadcast Studio (studio159) is the industry's first purpose-built broadcast studio in Korea, equipped with a large high-resolution 500-inch LED display with 2.5mm pixel pitch, cutting edge audio-visual technology, and broadband speeds of up to 10 Gigagigabits per second (Gbps).

Located on the 2nd floor, studio159 and its control room house state-of-the-art technology to facilitate all forms of digital production, streaming, and broadcasting. From recording a podcast to distributing high-quality video and audio for YouTube and/or streaming a product launch, studio159, together with a team of Digital Event Strategist (DES) certified event specialists and our live streaming service, Coex Live, is a perfect studio to deliver a seamless event experience.

Venue	Dimensions		Area		Capacities
	m W x L x H (m)	ft W x L x H (m)	m ²	ft ²	TH
studio159	14x21x5.8~4.9	45.9x68.8x19~16	294	3,164.5	70~100
Room1	6.7x4.8x3	21.9x15.7x9.8	32	344	-
Room2	4.9x4.9x3	52.7x52.7x9.8	24	258	-
Lobby	-	-	150	1,614.5	-

Location

2F

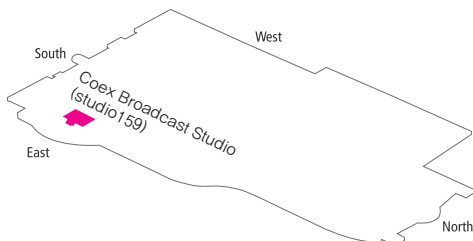

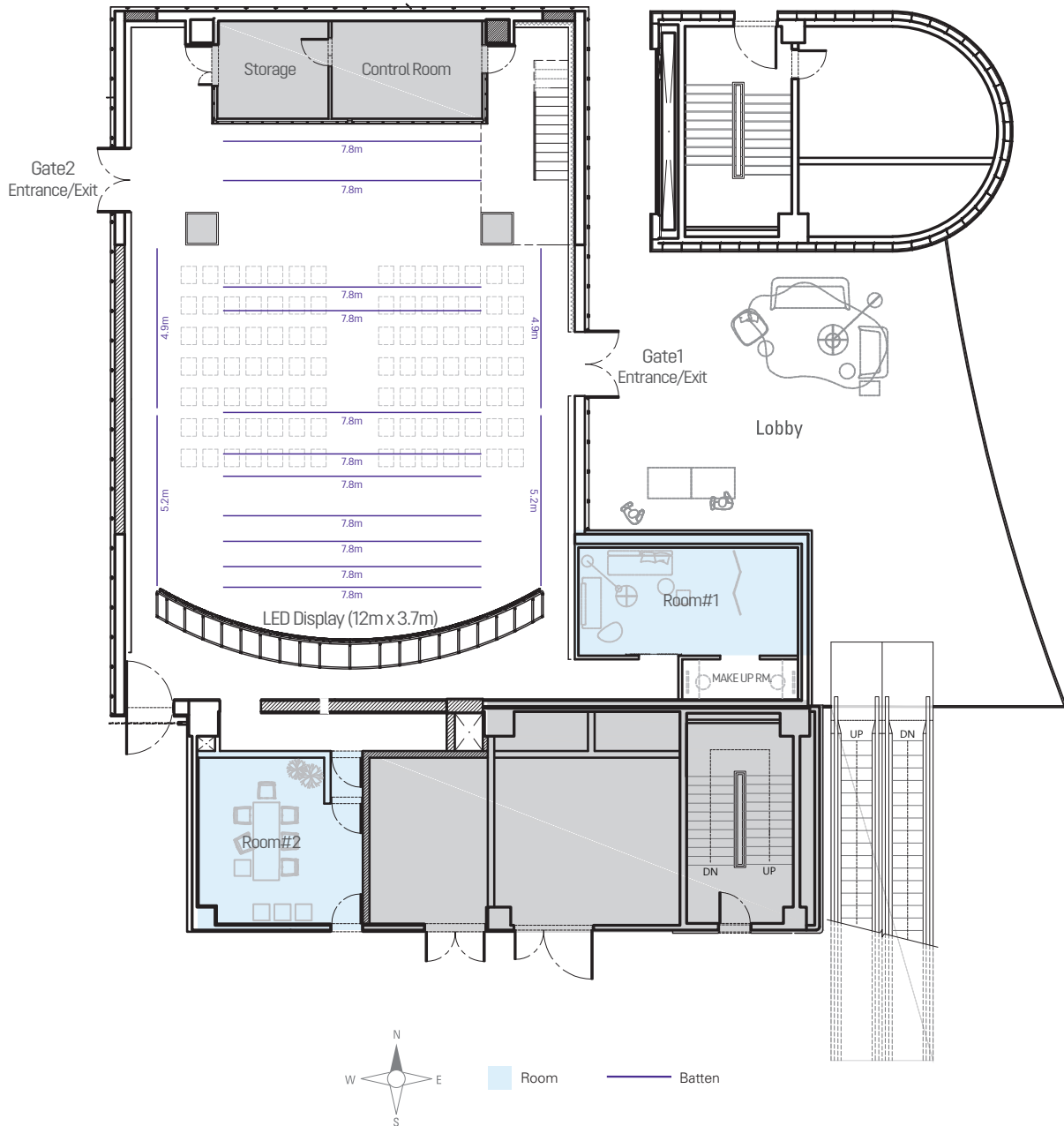

Details

Location	- 2nd floor	Key features	- High resolution 500" LED Display(12m x 3.7m, 4,800 x 1,485px, Pitch 2.5mm) - A/V system (4K camera, A/V and lighting system, rigging) - Broadband connectivity with speed up to 10Gbps - Lobby, 2 auxiliary rooms(green room/vip room), control room
Floor Space	- 294m ² (3,164.5ft ²)		
Use	- Virtual/hybrid events, podcasts, live streaming and video production		
Capacity	- 70~100 delegates (TH style)		

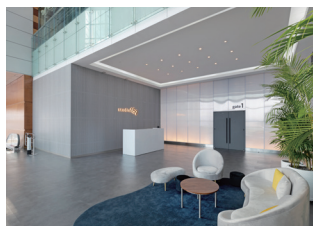

AUDITORIUM

coex
EXPECT THE BEST.
EXPERIENCE EVEN MORE

Excellent Theater Ambience

The Auditorium is located on the third floor and seats 1,080 visitors. Its luxurious and striking atmosphere never fails to impress. It is furnished with state-of-the-art equipment, including LED Screen and provides excellent acoustics and visibility. The theater-style room is a popular venue for film previews, award ceremonies, musicals, concerts, and opening ceremonies. Each seat comes with a fold-away tray and an earphone jack that is directly connected to the built-in audio system with twelve translation booths. In addition, four rooms on the third and fourth floor of the Auditorium can be utilized for various purposes such as VIP rooms or press rooms. The Auditorium's 990m² lobby can be used for receptions, registration areas, or for auxiliary exhibitions. The eight entrances around the Auditorium allow for easy access during busy periods, and automated double swing doors make it easier to control large crowds during concerts or seminars.







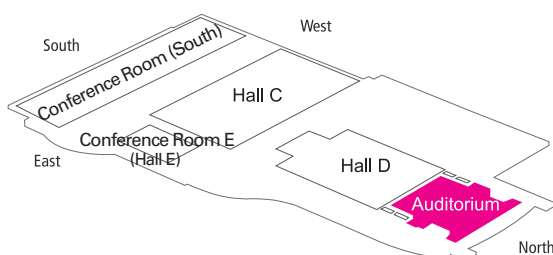

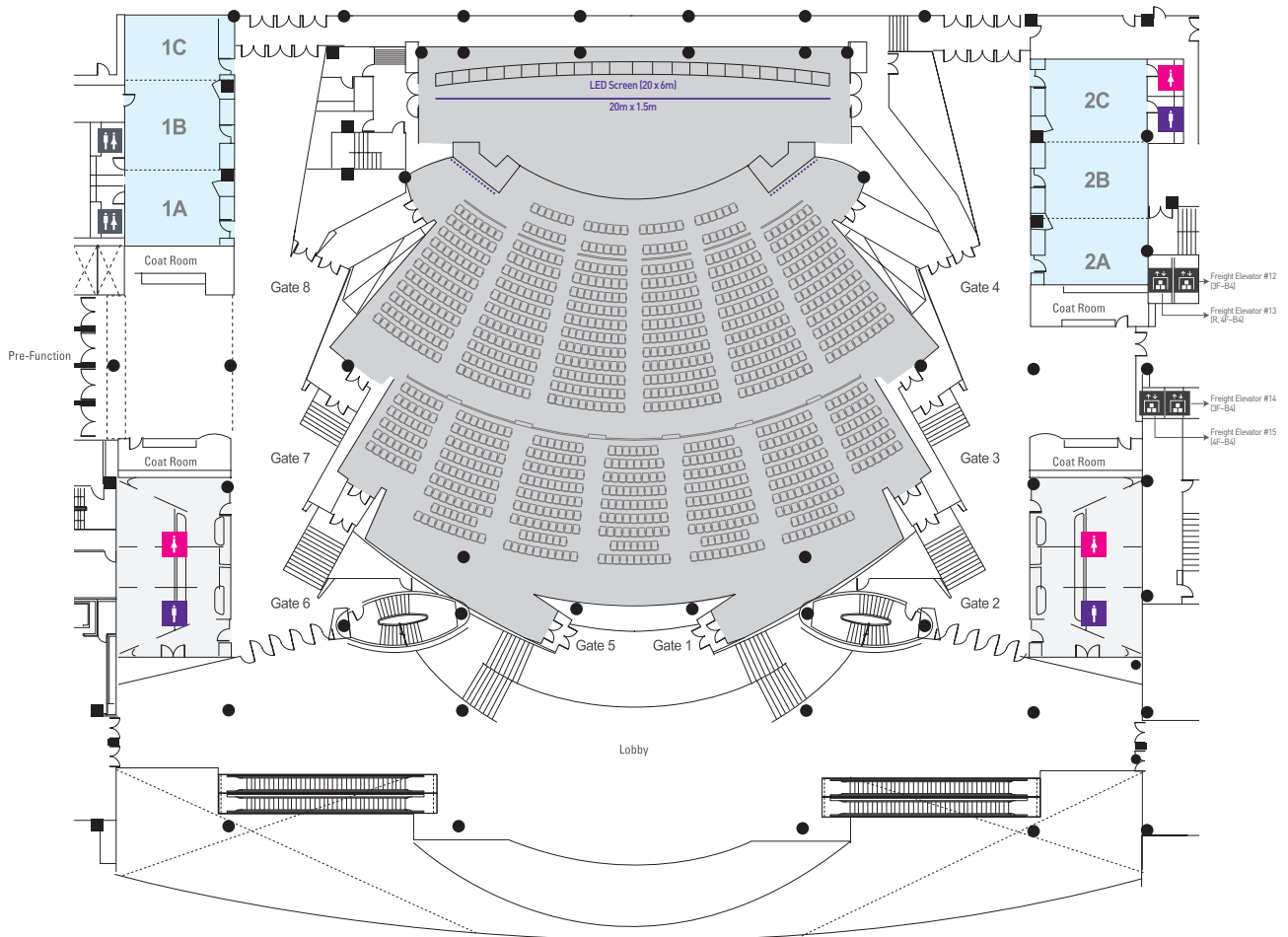
Venue	Dimensions		Area		Capacity		
	W x L	W x L	m ²	ft ²	CL	TH	BQ
Auditorium	37x31	121.4x101.7	2,104	22,647	-	1,080	-
Meeting Room 1	7.4x18	24.3x59.1	144	1,550	63	120	80
Meeting Room 2	7.4x18	24.3x59.1	144	1,550	63	120	80
Meeting Room 3	7.4x12.4	24.3x40.7	104	1,119	45	90	50
Meeting Room 4	7.4x12.4	24.3x40.7	104	1,119	45	90	50

Location

3F





-  Unisex Washroom (Inside the meeting room)
-  Men's Washroom
-  Women's Washroom
-  Freight Elevator
-  Dressing Room
-  Auditorium meeting room
-  Batten
-  Screen

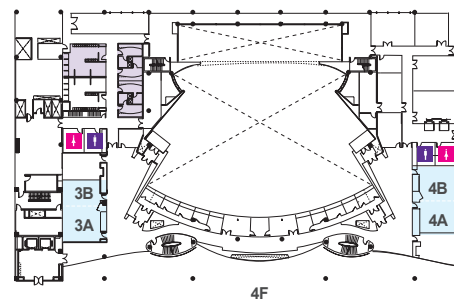

Details

- Location** - 3rd floor
- Floor Space** - 2,104m²
- Use** - International conferences, plenary sessions, awards ceremony, stage-based events, musicals
- Capacity** - 1,080 seated capacity in theater-style

- Main Facilities**
 - AV and lighting system
 - Interpretation booths (4th floor)
 - Main stage : 12m (W) x 24m (L) x 11m (H)
 - LED Display : 20m x 6m, 5,120px x 1,536px, Pitch 3.9mm
 - 2 Built-in screen in each stage rack (240" each)
 - Batten bar (20m x 1.5m) 9ea
- Other Features**
 - 4 Coat rooms (3rd floor)
 - Dressing rooms
 - 8 Gates (entrance/exit)
 - Pre-function / foyer areas
 - 4 Auditorium meeting rooms
 - *3F (Room #1, #2), 4F (Room #3, #4)
 - 2 DID signage in foyer: 65" monitor (1,920 x 1,080 pixels)

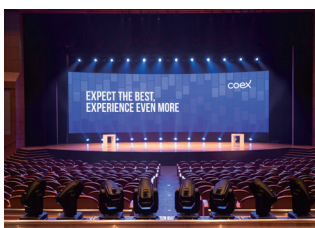

CONFERENCE ROOM E (HALL E)

Unique Venue

Located on the third floor of Coex, Conference Room E can be partitioned into eight sections and offering numerous layouts as a multipurpose room. Larger conferences often use the lobby of Conference Room E as a lounge, networking area, space for exhibition booths, or registration. Conference Room E is also an ideal space for specialized long-term, seasonal programs.

Venue	Dimensions		Area		Capacity		
	W x L x H (m)	W x L x H (ft)	m ²	ft ²	CL	TH	BQ
E1	9.7x18.7x3.6	31.8x61.4x11.8	182	1,953	81	168	80
E2	8.9x16.7x3.6	29.2x54.8x11.8	149	1,601	72	144	70
E3	8.9x16.7x3.6	26.2x54.8x11.8	134	1,436	72	144	70
E4	8x18.7x3.6	26.6x61.4x11.8	152	1,634	78	164	70
E1~E4	35.8x18.7x3.6	117.5x61.4x11.8	617	6,624	306	624	290
E5	18.7x18.7x3.6	61.4x61.4x11.8	350	3,770	162	320	120
E6	18.7x17x3.6	61.4x55.8x11.8	318	3,427	144	288	120
E5~E6	18.7x35.8x3.6	61.4x117.5x11.8	668	7,197	324	600	320
E1~E6	44.8x35.8x3.6	147.0x117.5x11.8	1,604	17,273	810	1,232	780
E7	9.1x14.7x3.5	29.9x48.3x11.5	134	1,445	75	140	60
E8	5.1x8.9x3.3	16.8x29.2x10.9	46	491	24	40	20

Location

3F

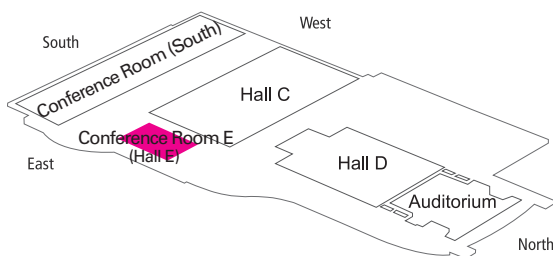

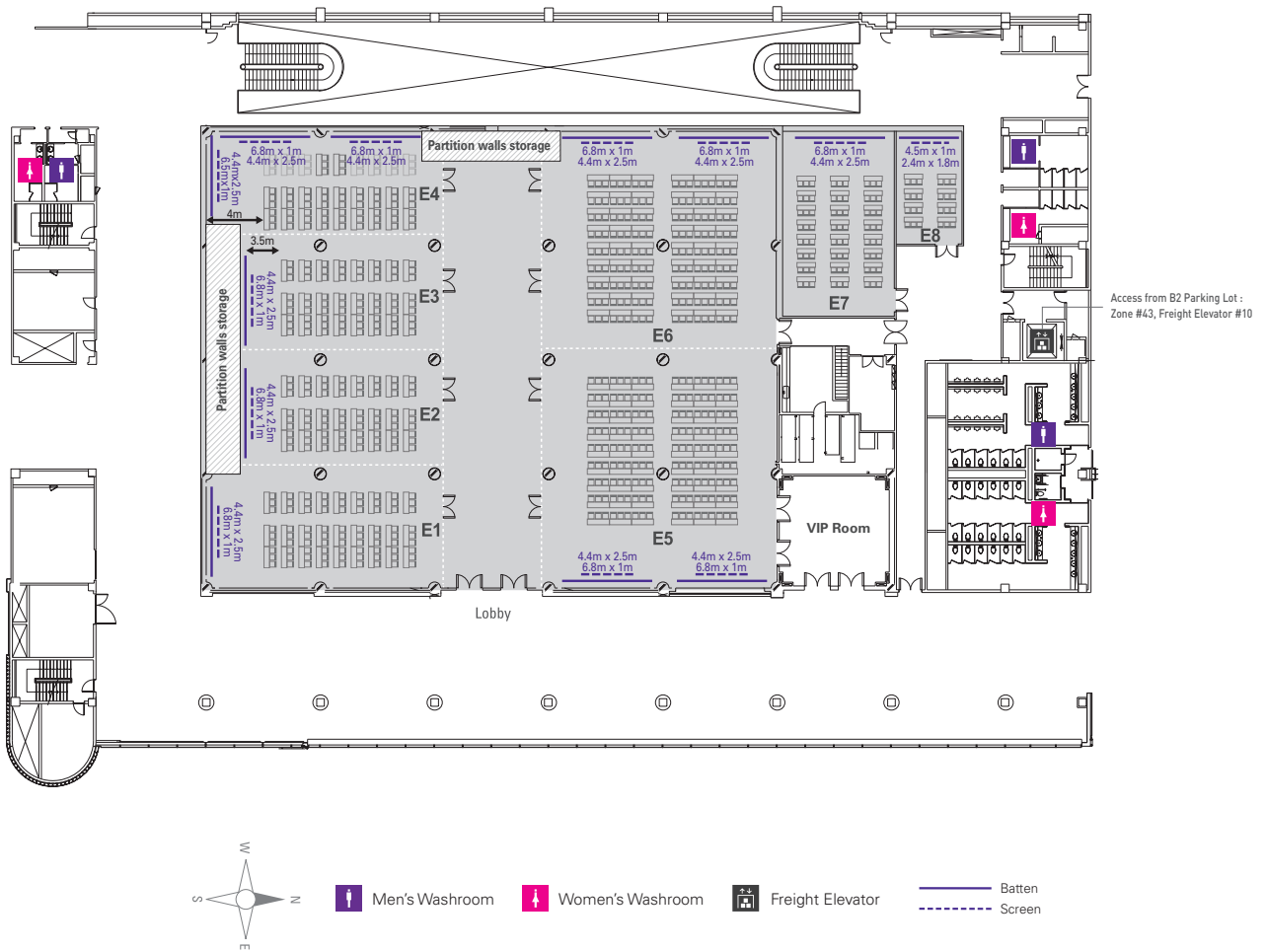

Details

Location	- 3rd floor	Main Facilities	- AV system - Retractable screens (4.4m x 2.5m), (2.4m x 1.8m) - Ceiling-mounted projector : 8,000 Lumen - 65" DID signage in foyer (1,920 x 1,080 pixels)
Floor Space	- 1,784m ² : partitions into 8 sections		
Use	- Seminars, workshops, banquets		
Capacity	- 1,500 people		



CONFERENCE ROOM SOUTH 3F

Premium Meeting Facilities

Specifically designed for smaller meetings and seminars, Conference Room South on the third floor offers a lot of flexibility. In total, there are 29 rooms that can be divided into 50 smaller rooms. Five larger rooms (seating capacity of 300) and 24 medium and small-sized rooms allow for various combinations within close proximity to each other. Conference Room South is located adjacent to Coex's specialized exhibition halls, Hall A and Hall C. It is therefore an ideal place to hold exhibition-related seminars. The 207m² conference spaces come equipped with translation booths while the smaller 54m² rooms all have fully automated screens.

Details

Location	- 3rd floor	Main Facilities	- A/V system (rooms larger than 207m ²) - Ceiling-mounted projector : LCD 6200 Lumen (rooms larger than 207m ²) - Interpretation booths (rooms larger than 207m ²) *Excluding room #300, 308 - Fixed built-in stage : 8m x 3m x 0.2m (rooms larger than 207m ²) - Batten bar for banner (103m ²) - 300 LED screen: 5.5m x 3m (2,115 x 1,153 pxl) - 328 LED screen : 4m x 2.3m (1,344 x 768 pxl) - #300 digital signage: 55" (1,080 x 1,920 pixels) - #301~327 digital signage: 32" (1,080 x 1,920 pixels) *Excluding rooms smaller than 54m ² and room #328
Floor Space	- Small and medium sized rooms from 40m ² to 310m ² *Partitioned into a total of 50 sections		
Use	- Conferences, seminars, workshops, banquets, interview.		
Capacity	- 20~300 people		

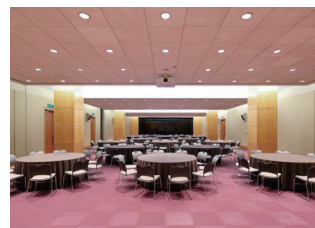



Location

3F

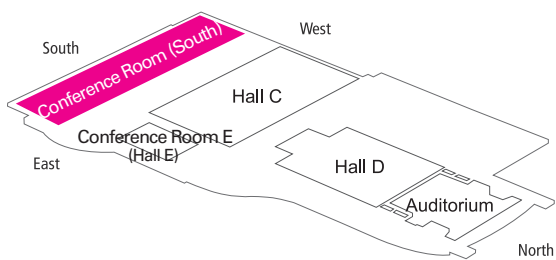

CONFERENCE ROOM SOUTH 3F

Venue	Dimensions		Area		Capacity		
	W x L x H (m)	W x L x H (ft)	m ²	ft ²	CL	TH	BQ
300	14x18x3.5	45.9x59.1x11.5	264	2,842	114	168	100
301A	7.3x12.7x3.3	24x41.7x10.8	104	1,119	54	100	50
301B	12.7x9.7x3.3	41.7x31.8x10.8	103	1,109	54	100	30
301	12.7x17.9x3.3	41.7x58.7x10.8	207	2,228	99	168	90
302	3.8x9x3.1	12.5x29.5x10.2	40	431	20	40	20
303	3.9x9.5x3.1	12.8x31.2x10.2	40	431	20	40	20
304	6.2x9x3.1	20.3x29.5x10.2	54	581	24	48	20
305	6.2x9x3.1	20.3x29.5x10.2	54	581	24	48	20
306	3.8x9x3.1	12.5x29.5x10.2	40	431	20	40	20
307A	8x12.9x3.3	26.2x42.3x10.8	104	1,119	54	100	50
307B	10x12.9x3.3	32.8x42.3x10.8	104	1,119	54	100	50
307C	12.9x8.5x3.3	42.3x27.9x10.8	103	1,109	48	100	30
307	12.9x26.8x3.3	42.3x87.9x10.8	311	3,348	156	300	120
308A	8x12.9x3.3	26.2x42.3x10.8	104	1,119	54	100	50
308B	10x12.9x3.3	32.8x42.3x10.8	104	1,119	54	100	50
308C	12.9x8.5x3.3	42.3x27.9x10.8	103	1,109	48	100	30
308	12.9x26.8x3.3	42.3x87.9x10.8	311	3,348	156	300	120
309	3.9x9.5x3.1	12.8x31.2x10.2	40	431	20	40	20
310	6.2x9x3.1	20.3x29.5x10.2	54	581	24	48	20
311	6.2x9x3.1	20.3x29.5x10.2	54	581	24	48	20
312	3.8x9x3.1	12.5x29.5x10.2	40	431	20	40	20
313	3.9x9.5x3.1	12.8x31.2x10.2	40	431	20	40	20
314	6.2x9x3.1	20.3x29.5x10.2	54	581	24	48	20
315	6.2x9x3.1	20.3x29.5x10.2	54	581	24	48	20
316	3.8x9x3.1	12.5x29.5x10.2	40	431	20	40	20
317A	8x12.9x3.3	26.2x42.3x10.8	104	1,119	54	100	50
317B	10x12.9x3.3	32.8x42.3x10.8	104	1,119	54	100	50
317C	12.9x8.5x3.3	42.3x27.9x10.8	103	1,109	48	100	30
317	12.9x26.8x3.3	42.3x87.9x10.8	311	3,348	156	300	120
318A	8x12.9x3.3	26.2x42.3x10.8	104	1,119	54	100	50
318B	10x12.9x3.3	32.8x42.3x10.8	104	1,119	54	100	50
318C	12.9x8.5x3.3	42.3x27.9x10.8	103	1,109	48	100	30
318	12.9x26.8x3.3	42.3x87.9x10.8	311	3,348	156	300	120
319	3.9x9.5x3.1	12.8x31.2x10.2	40	431	20	40	20
320	6.2x9x3.1	20.3x29.5x10.2	54	581	24	48	20
321	6.2x9x3.1	20.3x29.5x10.2	54	581	24	48	20
322	3.8x9x3.1	12.5x29.5x10.2	40	431	20	40	20
323	3.9x9.5x3.1	12.8x31.2x10.2	40	431	20	40	20
324	6.2x9x3.1	20.3x29.5x10.2	54	581	24	48	20
325	6.2x9x3.1	20.3x29.5x10.2	54	581	24	48	20
326	3.8x9x3.1	12.5x29.5x10.2	40	431	20	40	20
327A	8x12.9x3.3	26.2x42.3x10.8	104	1,119	54	100	50
327B	10x12.9x3.3	32.8x42.3x10.8	104	1,119	54	100	50
327C	12.9x8.5x3.3	42.3x27.9x10.8	103	1,109	48	100	30
327	12.9x26.8x3.3	42.3x87.9x10.8	311	3,348	156	300	120
328	6.6x13.9x2.9	21.7x45.6x9.5	96	1,033	42	80	50

※All capacities subject to floorplan approval.

Grand Conference Room Conference Room(S) 4F



Theater Plus Meeting Space

Located on the fourth floor of Coex, Conference Room South(Room 401) is a theater-style conference room that seats 441. Three adjacent small to large sized conference rooms are perfect for other related banquets, seminars, or workshops. Tiered seating in Room 401 allows for excellent visibility and audience participation in a more intimate arrangement. Conference Room South on the fourth floor is often used for anniversaries and annual events connected to government agencies, associations, and other groups. Fixed screens, lightings, and high-end A/V systems facilitate the production of any necessary effects for musicals or other live performances. Wood veneer gives all four rooms a warm, relaxed atmosphere. The lobby draws in natural sunlight, making it the ideal place for coffee breaks, receptions, or registration areas.

Venue	Dimensions		Area		Capacity		
	W x L x H (m)	W x L x H (ft)	m ²	ft ²	CL	TH	BQ
400	5.6x13.8x3.4	18.4x45.3x11.2	78	834	(Fixed Type) BD 20		
401	16x34x7	52.5x111.5x23	489	5,264	(Fixed Type) TH 441		
402	16.9x16.5x3.4	55.4x54.1x11.2	324	3,488	168	312	160
403	8x16x3.2	26.2x52.5x10.5	144	1,550	72	140	60

Location

4F

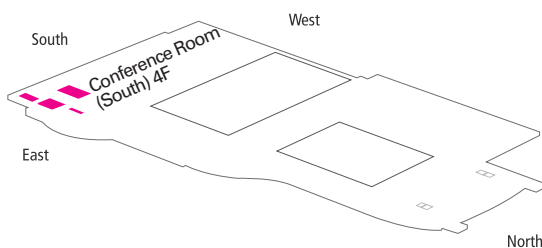

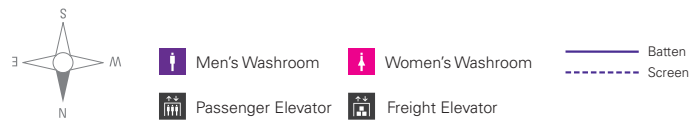
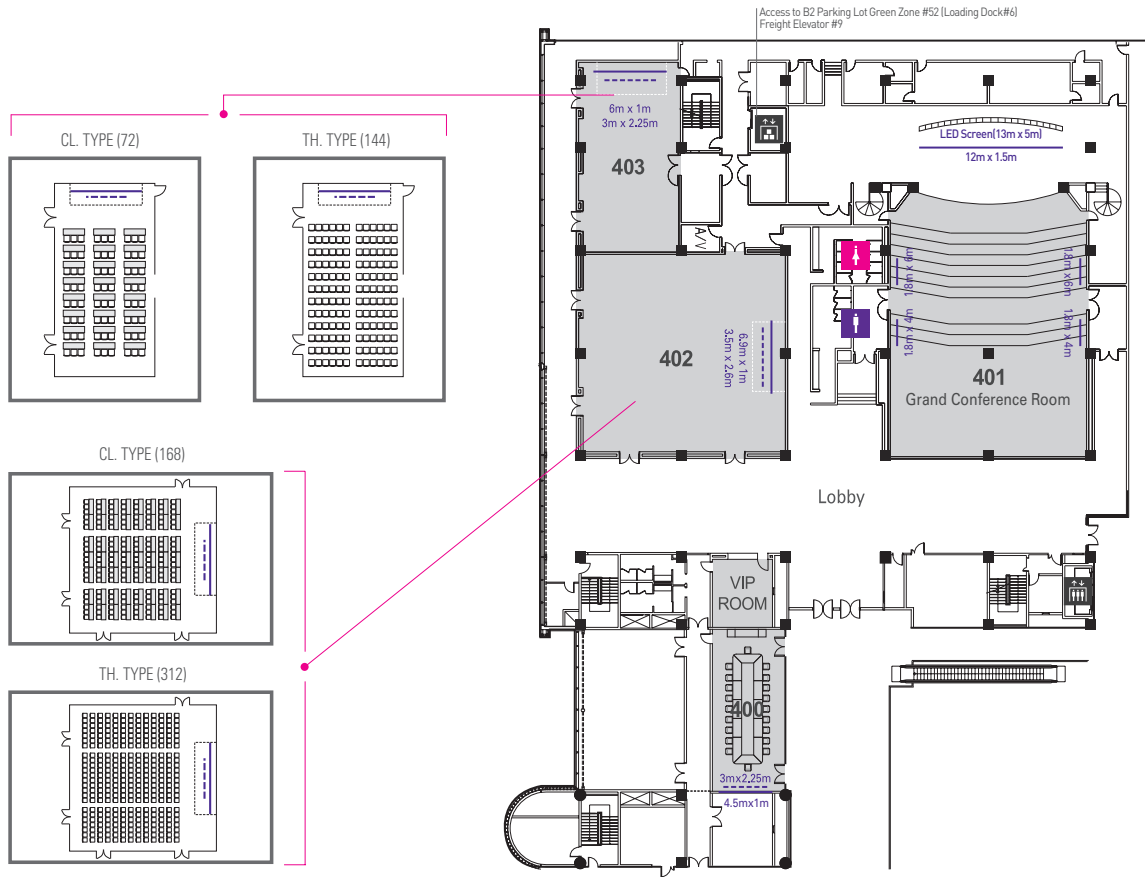

Details

	Grand Conference Room 401		400, 402~403
Location	- 4th floor	Location	- 4th floor
Floor Space	- 489m ²	Floor Space	- A/V system - Retractable screens (4.4m x 2.5m), (2.4m x 1.8m) - Ceiling-mounted projector : 8,000 Lumen
Use	- Int'l conferences, symposia, seminars, award ceremonies, musicals, showcases and other corporate presentations	Use	- 400(fixed boardroom style) : VIP lounge, board meeting. - 402~403 : Conference, seminars, banquets
Capacity	- 441 seated capacity in theater-style	Capacity	- 22(400), 140~300 people(402~403)
Main Facilities	- A/V system and lighting system - 2 Interpretation booths - Stage : 9.4m (W) x 13m (L) x 6m (H) - Built-in LED Screen : 13m x 5m (3328pxl x 1280pxl) - DID signage: 32" (1,080 x 1,920 pixels)	Main Facilities	- A/V system - Stage : 3m x 11m x 0.2m(402), 2.5m x 6m x 0.2m(403) - Auto screen : 3.3 x 1.85m(400), 3.6 x 2.7m(402), 3m x 2m(403) - Banner bartens : 4.5m x 1m (400), 6.9m x 1m (402), 6m x 1m (403) - #402, 403 digital signage: 32" (1,080 x 1,920 pixels)

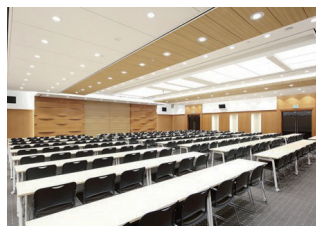

Digital & Hybrid Venue

The #1 Video Platform for Webinars, Summits & Virtual Conferences
코엑스 웨비나 서비스
 최우수, 최강 기능 등을 통해 참여율은 높이고 별도의 장비 구축 없이 시간과 비용을 혁신적으로 절약해 드립니다.

Including the exhibition halls and meeting rooms, Coex Convention Center is under the process of digital transformation. Coex is equipped with 10-gigabit internet and has established a Broadcast Studio furnished with state-of-the-art facilities and equipment to deliver seamless virtual and hybrid events.

Additionally, Coex is offering modern LED screens, upgraded audio visual products, and live streaming and digital event platforms.

Plan your next hybrid event with Coex, the Korea's Leading Event Organizer!

Location	LED Size	LED Pixel	LED Refresh Rate	LED Brightness
2F, Studio159	12mx3.7m	4,800x1,485 (Pixel pitch 2.5mm)	60Hz	1,000nits
3F, Auditorium	20mx6m	5,120x1,536 (Pixel pitch 3.9mm)	60Hz	1,000nits
3F, Conference Room South, 300	5.5mx3m	2,115x1,153 (Pixel pitch 2.6mm)	3,840Hz	1,200nits
3F, Conference Room South, 328	4mx2.3m	1,344x768 (Pixel pitch 3mm)	1,920Hz	1,000nits
4F, Conference Room South, 401	13mx5m	3,328x1,280 (Pixel pitch 3.9mm)	3,840Hz	1,400nits



2F, Studio159



3F Auditorium



3F, Conference Room South, 300



3F, Conference Room South, 328



4F, Conference Room South, 401

XPACE (Coex Digital Space) is the state-of-the-art, high definition digital media display screens at Coex and consists of the vertical big media (Big Bridge and Edge Columns) and horizontal media (Bridge and Floor). As the MICE advertisement platform, XPACE offers the perfect branding opportunity to command the attention of millions of visitors, tourists and Coex MICE Complex employees year-round, and will deliver instant brandscaping results. In addition, Xpace signage help reduce human waste and carbon dioxide emissions by cutting down on print-based advertising.

Xpace Coex Digital Space

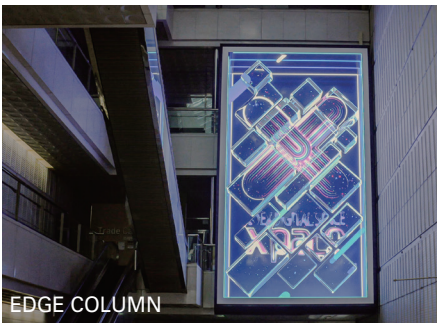
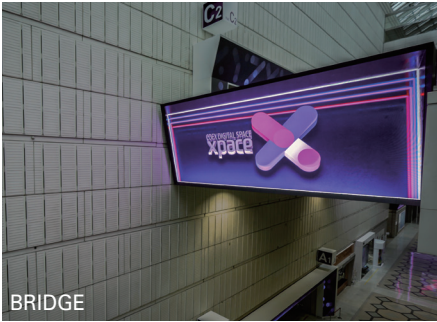
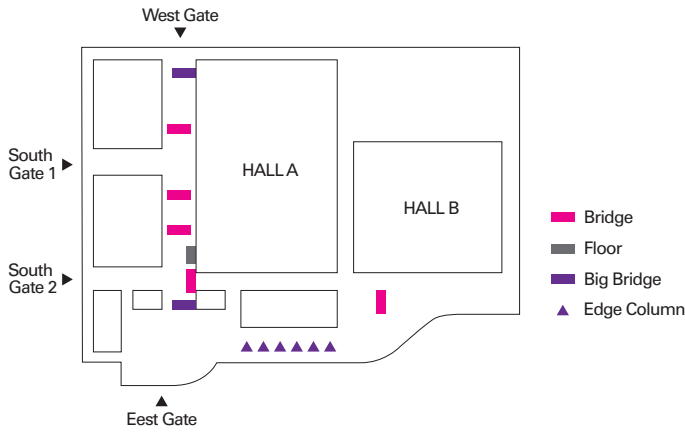

Media	Location	Size(Resolutions)	Note
Bridge	Third Floor	6.7m x 2.9m (1,680px x 720px) - 5 locations	
Floor	First Floor, Located at the lobby of Hall A	4.2m x 2.4m (3,840px x 2160px) - 1 location	
Big Bridge	Stretching over from second to third floor, Located at the East & West Gates	6.4m x 11.2m (1,600px x 2,800px) - 2 locations	Audio Available
Edge Column	First Floor, Located on the pathway between Hall A and B	Front 3.8m x 4.3m (960px x 2,160px), two-sided Back 2.2m x 4.3m (560px x 1,000px) 1 side	6 locations Audio Available

EXHIBITION HALL A

High Impact Exhibitions

Located on the first floor, Hall A has a total floor space of 10,368m²(fits 520 booths). Hall A is ideal for large exhibitions and specialized events, including meetings. It is the number one venue for consumer exhibitions, not only because of its size but because of its location right next to the entrance of Starfield Coex Mall.

Recent renovations in Hall A have led to a more eco-friendly exhibition environment. Newly installed LED lights save energy while maintaining a consistent brightness during exhibitions. Polished concrete floors allow for a carpet free, reduced-waste exhibition environment.

Hall	Dimensions		Ceiling Height		Usable Area	
	Meters	Feet	Meters	Feet	Sq.Meters	Sq.Ft
Hall A	144.0 x 72.0	472.4 x 236.2	7.5/9.0	24.6/29.5	10,368	111,600

* Ceiling height varies(refer to detailed image)

Location

1F

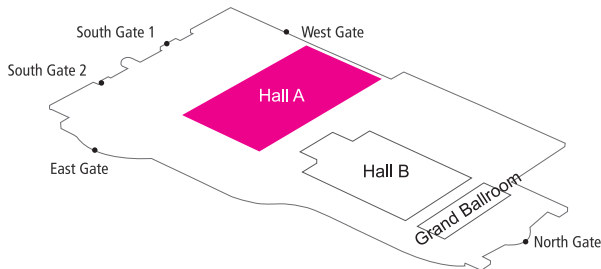

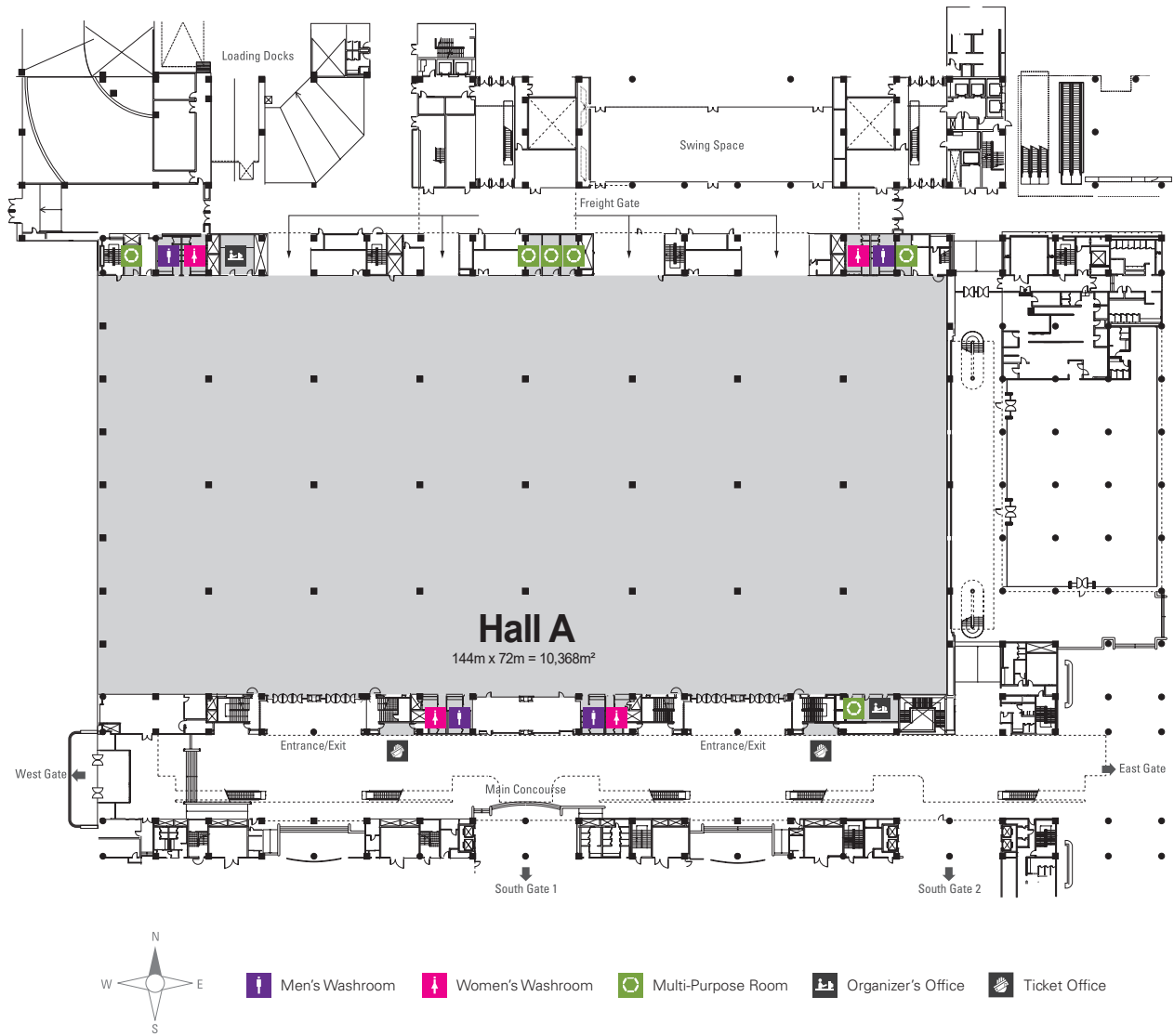

Details

Location	- 1st floor	Key features	- Floor : Epoxy coating flooring - Floor pits and trenches : water and drainage, compressed air pipework, electricity, and telecommunication services - Distance between pillars : 18m - Floor loading : Capacity of 1.5 tons/m ² - Connected to Hall B via swing space
Floor Space	- 10,368m ² with pillars * Hall A cannot be dividable into smaller halls		
Capacity	- 520 booths (1 booth = 3m x 3m)		
Ceiling Height	- 9m	Additional Facilities	- 4 Organizer's office space (2 are located on mezzanine level) - 6 Multi-purpose rooms (size 13m ² ~21m ²)



EXHIBITION HALL B

Space-Efficient, Flexible Venue

Located on the first floor adjacent to Hall A, Hall B consists of an exhibition hall (7,290m²) and a swing space (S/S, 720m²) through which it can be combined with Hall A to hold specialized exhibitions and large-scale meetings. The hall can accommodate up to 360 booths and it can be divided into two sections. The few pillars in the hall are spaced out in wide enough intervals to grant maximum flexibility in managing the area. The spacious lobby just outside of Hall B can be used for registration or opening ceremonies. Also, loading docks in close proximity make event preparations relatively quick and easy. Polished carpet-free floors and LED lighting create a more sustainable exhibition environment.

Hall	Dimensions		Ceiling Height		Usable Area	
	Meters	Feet	Meters	Feet	Sq. Meters	Sq. Ft
B1	45.0 x 81.0	1476 x 265.7	9.5	31.2	3,645	39,235
B2	45.0 x 81.0	1476 x 265.7	9.5	31.2	3,645	39,235
1+2	90.0 x 81.0	295.3 x 265.7	9.5	31.2	7,290	78,470
Swing Space	18.0 x 40.0	59.1 x 131.2	6.2	20.3	720	7,750

Location

1F

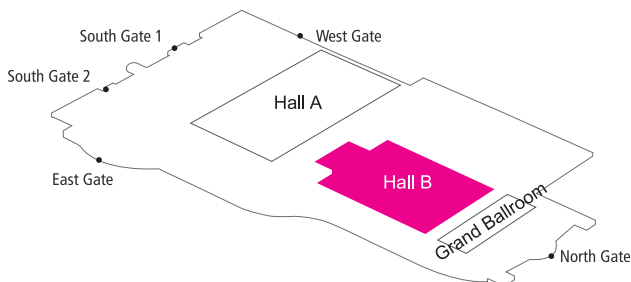



Details

Location	- 1st floor (near North Gate)	Key features	- Floor : Polishing finish - Floor pits and trenches : water and drainage, compressed air pipework, electricity, and telecommunication services - Distance between pillars : 18m, 27m - Floor loading : Capacity of 1.5 tons/m ² - Swing space : 720m ² *Space used as exhibition space, loading corridor or passageway - Connected to Hall A and Grand Ballroom
Floor Space	- 8,010m ² (Including Swing space of 720m ²) *Can be divided into 2 sections (B1, B2)		
Capacity	- 360 booths (1 booth = 3m x 3m)		
		Additional Facilities	- 1 Organizer's office on mezzanine floor (area : 126m ²) - 1 Multi-purpose room at each freight gate (area : 60m ²)



EXHIBITION HALL C

Features a Pillar-Free Area for Multi-Purpose Events

Hall C, featuring 10,348m² of space, is located on the third floor and the pillar-free area within Hall C can accommodate up to 5,000 people. Additionally, Hall C can be partitioned into 3 sections, allowing specialized exhibition with an event stage or and large-scale meetings. Epoxy coating flooring create an clean environment and its efficient vents keep the air well-circulated while the energy efficient LED lighting can reduce energy and rental costs for event organizers.

Hall	Dimensions		*Ceiling Height		Usable Area	
	Meters	Feet	Meters	Feet	Sq.Meters	Sq.Ft
C1	36.0 x 72.0	118.1 x 236.2	8.0	26.3	2,572	27,900
C2	36.0 x 72.0	118.1 x 236.2	12.3	40.4	2,592	27,900
C3	36.0 x 72.0	118.1 x 236.2	12.3	40.4	2,592	27,900
C4	36.0 x 72.0	118.1 x 236.2	8.0	26.3	2,592	27,900
1+2+3+4	144.0 x 72.0	472.4 x 236.2	-	-	10,348	111,600

* Ceiling height varies (refer to detailed image)

Location

3F

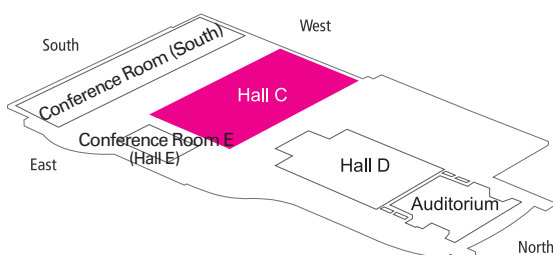

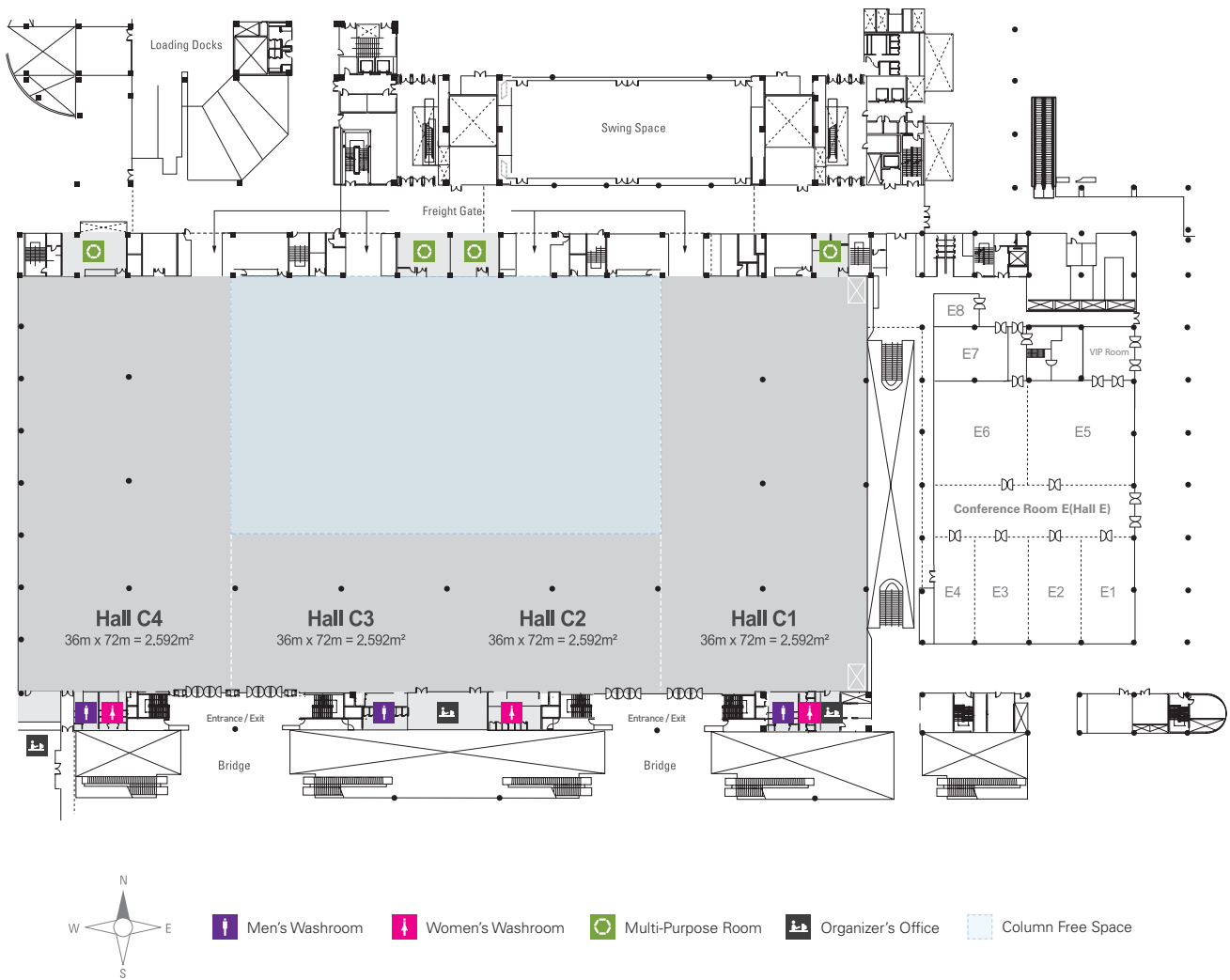

Details

Location	- 3rd floor (Directly above Hall A)	Key features	- Floor finish : Epoxy coating flooring - Floor pits and trenches : water and drainage, compressed air pipework, electricity, and telecommunication services - Distance between pillars : 18m - Ceiling Height : 8m (C2,3 Column Free Space 12.3m) - Floor loading : Capacity of 1.5 tons/m ² - Connected to Hall D
Floor Space	- 10,348m ² with pillars *Can be divided into 2 or 3 sections	Additional Facilities	- 3 Organizer's offices (2 are located on mezzanine level) - 4 Multi-purpose rooms near freight gate (area : 23m ² ~ 62m ²)
Capacity	- 520 Booths (1 booth = 3m x 3m)		
Ceiling Height	- 8m *Area marked in blue is 12.3m		



EXHIBITION HALL D

Vast Multi-Functional Pillarless Space

With a capacity of up to 7,000 people, Hall D is one of the largest pillar-free halls in the country. Located on the third floor, the hall covers 7,281m² - larger than a football field - and can be partitioned into two halls with a 9 meter girth. The organizer's office is located one floor above, overlooking the space for easy control and monitoring of events.

Hall D can be used for exhibitions as well as conventions. Its honey-colored interior gives it a warm atmosphere despite its size, making Hall D an ideal choice for opening and closing ceremonies for large-scale international conferences, fashion shows, concerts and general assemblies. The entire hall is pillar-free, allowing for maximum utilization of the space. Like Coex's other exhibition halls, Hall D features convenient loading docks and trench infrastructure with access to electrical, communications, water, and compressed air, as well as carpet-free flooring and LED lighting.

Hall	Dimensions		Ceiling Height		Usable Area		Capacities		
	Meters	Feet	Meters	Feet	Sq.Meters	Sq.Ft	CL	TH	BQ
D1	36.0 x 81.0	118.1 x 265.7	17.5	57.4	2,916	31,388	1,600	3,200	1,600
D2	45.0 x 81.0	147.6 x 265.7	17.5	57.4	3,645	39,235	1,900	3,800	1,900
1+2	81.0 x 81.0	265.7 x 265.7	17.5	57.4	6,561	70,623	3,500	7,000	3,500
Swing Space	18.0 x 40.0	59.1 x 131.2	9.3	30.5	720	7,750			

Location

3F

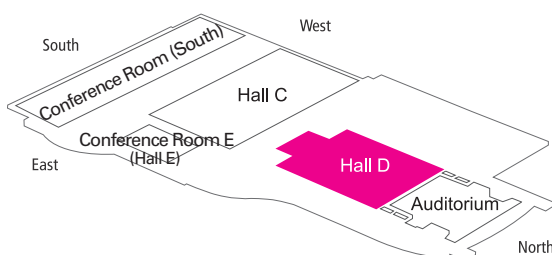

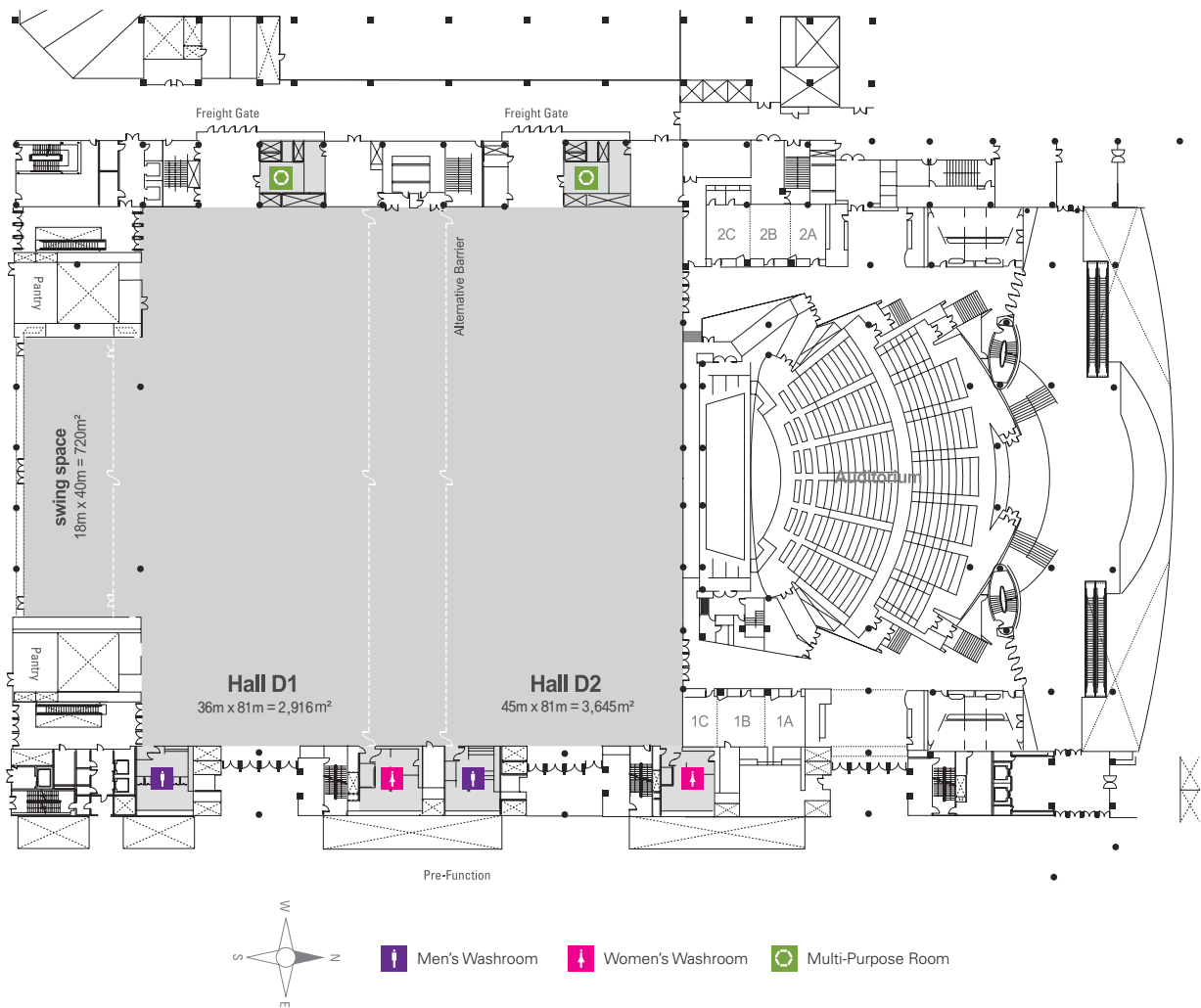

Details

Location	- 3rd Floor (Directly above Hall B)	Key features	- Floor finish : Epoxy coating flooring - Floor pits and trenches : water and drainage, compressed air pipework, electricity, and telecommunication services - Floor loading : Capacity of 1.5 tons/m ² - Swing space : 720m ² of space for stage set up, as loading corridor - Connected to Hall C via swing space
Floor Space	- 7,281m ² of pillarless space (Including Swing space of 720m ²) *Can be divided into D1 and D2	Additional Facilities	- 1 Organizer's office on 4th floor (area : 126m ²) - 2 Multi-purpose rooms near the freight gates (area : 32.5m ²)
Capacity	- 360 booths (1 booth 3m x 3m) Maximum capacity of 7,500 guest		
Use	- Large int'l meetings, banquets, fashion shows, award ceremonies, corporate dinners, plenary sessions.		



Capacity Summary

MEETING ROOMS/SPACE

Venue	Dimensions W x L x H (m)	Area(m ²)	Capacity			Banner				Beam Projector			Stage(m) (Width x Length x Height)	Etc		
			CL	TH	BQ	Horizontal banner(m) (Width x Length)	Vertical banner(m) (Width x Length)	Banner (batten) Location	Banner display method	Screen (m) (Width x Length)	Screen ratio	Projector (Lumen)		Number of rentable wireless microphones	Type of podium	
1F Grand Ballroom	101	13x22.3x4.5	299	150	288	150	10x1	1.5x4.5	Behind the screen	Tack/Cable tie	7x4(300")	16.9	16,000	Mobile stage (per 1 unit 2.4x1.2x0.6)	2	2 A/B/C
	102	13.22.3x4.5	299	150	288	150	10x1/12x1	1.5x4.5	Behind the screen	Tack/Cable tie	7x4(300")/6x4.5(300")	16.9	16,000		2	2 A/B/C
	103	26.9x22.3x4.5	621	300	600	280	9X1/12X1 (right)	1x4.5	Behind the screen	Tack/Cable tie	7x4(300")/6x4.5(300")	16.9	16,000		4	2 A/B/C
	104	13x22.3x4.5	299	150	288	150	10x1	1.5x4.5	Behind the screen	Tack/Cable tie	7x4(300")	16.9	16,000		2	2 A/B/C
	105	12.9x22.3x4.5	299	150	288	150	10X1/12X1 (right)	1.5x4.5	Behind the screen	Tack/Cable tie	7x4(300")/6x4.5(300")	16.9	16,000		2	2 A/B/C
	101-105	79x22.3x4.5	1,817	900	1,800	900	Negotiable	1.5x4.5	Behind the screen	Tack/Cable tie	7x4(300")	16.9	16,000		Negotiable	Negotiable
	Lobby						22x3 (Ceiling)		Entrance at 103 (*Lift required)	Cable tie						
2F Conference Room (North)	201	14.5x23x3.7	341	180	360	150	5x1	1x2.3	Behind the screen	Magnet/ Cable tie	3.38x2 (150")wide	16.9	7,000 (DLP/WUXGA)	Mobile stage (per 1 unit 2.4x1.2x0.4)	2	2 A/B/C
	202	15.2x23x3.7	341	180	360	150	8x1	1.5x2.9	Behind the screen	Magnet/ Cable tie	4.93x3 (220")wide	16.9	8,500 (DLP/WUXGA)		2	2 A/B/C
	203	14.5x23x3.7	341	180	360	150	5x1/8x1	1x2.3 1.5x2.9 (right)	Behind the screen	Magnet/ Cable tie	3.38x2(150")/ 4.93x2(220")right	16.9	7,000/8,500 (DLP/WUXGA)		2	2 A/B/C
	201-203 (ASEM Ballroom)	44.2x23x3.7	1,023	540	918	360	Negotiable	1x2.3 1.5x2.9	Behind the screen	Magnet/ Cable tie	3.38/4.93x2 (150/220")wide	16.9	7,000/8,500 (DLP/WUXGA)	Negotiable	Negotiable	
	204	9.9x2.8x2.9	28	12	24	-	-	-	-	-	-	-	-	-	-	Upon request
	205A	11x7x2.9	77	45	90	30	5.5x1	1x2.3	Behind the screen	Magnet/ Cable tie	3.38x2 (150")wide	16.9	5,000	-	1	2 A/B/C
	205B	11x7x2.9	77	45	90	30	5.5x1	1x2.3	Behind the screen	Magnet/ Cable tie	3.38x2 (150")wide	16.9	5,000	-	1	2 A/B/C
	205	11x14x2.9	154	84	160	80	5.5x1	1x2.3	Behind the screen	Magnet/ Cable tie	3.38x2 (150")wide	16.9	5,000	-	2	2 A/B/C
	206A	4.7x6.8x2.9	32	18	36	10	-	-	-	-	-	-	-	-	-	Upon request
	206B	4.7x6.8x2.9	32	18	36	10	-	-	-	-	-	-	-	-	-	
	206	9.4x6.8x2.9	64	36	60	30	-	-	-	-	-	-	-	-	-	
	207	4.4x6.8x2.9	32	18	36	10	-	-	-	-	-	-	-	-	-	
	208	9.9x2.8x2.9	28	12	24	-	-	-	-	-	-	-	-	-	-	
	209A	11x7x2.9	77	45	90	30	5.5x1	1x2.3	Behind the screen	Magnet/ Cable tie	3.38x2 (150")wide	16.9	5,000	-	1	
	209B	11x7x2.9	77	45	90	30	5.5x1	1x2.3	Behind the screen	Magnet/ Cable tie	3.38x2 (150")wide	16.9	5,000	-	1	1 B/C
	209	22x7x2.9	154	84	160	80	5.5x1	1x2.3	Behind the screen	Magnet/ Cable tie	3.38x2 (150")wide	16.9	5,000	-	2	2 B/C
210A	4.7x6.8x2.9	32	18	36	10	-	-	-	-	-	-	-	-	-	Upon request	
210B	4.7x6.8x2.9	32	18	36	10	-	-	-	-	-	-	-	-	-		
210	9.4x6.8x2.9	64	36	60	30	-	-	-	-	-	-	-	-	-		
211	4.4x6.8x2.9	32	18	36	10	-	-	-	-	-	-	-	-	-		
2F	Coex Broadcast Studio (studio159)	14x21x5.8-4.9	294	TH 70-110			15 lighting batten				Built-In-LED (500") 3.74m*12.1m (2.5pixel pitch)			-	2	Upon request
3F Auditorium & Meeting Rooms	Auditorium	37x31	2,104	(Fixed Type) TH 1,080			20x1.5	1.5x11	In front of the screen	Cable tie	Built-in-LED(20m x 6m, 3.9 pixel pitch)			24x11.5x1	4	2 A/C
	Lobby						15x1									
	R1	7.4x18x2.3-5.6	144	63	120	80	Negotiable	Negotiable	Negotiable	Negotiable	Mobile(100")	8,000	Mobile stage (per 1 unit 2.4x1.2x0.4)	-	1	Upon request (1 C)
	R2	7.4x18x5.6	144	63	120	80								-	1	
	R3	7.4x12.4x3.5	104	45	90	50								-	-	
R4	7.4x12.4x3.5	104	45	90	50	-								-		
3F Conference Room E (Hall E)	E1	9.7x18.7x3.6	182	81	168	80	6.8x1	1x2.8	Behind the screen	Tack/Cable tie	4.4x2.5(200")	16.9	8,000	Mobile stage (per 1 unit 2.4x1.2x0.4)	1	2 B
	E2	8.9x16.7x3.6	149	72	144	70	6.8x1	1x2.8	Behind the screen	Tack/Cable tie	4.4x2.5(200")	16.9			1	2 B
	E3	8.9x16.7x3.6	134	72	144	70	6.8x1	1x2.8	Behind the screen	Tack/Cable tie	4.4x2.5(200")	16.9			1	2 B
	E4	8x18.7x3.6	152	78	164	70	6.5x1/6.8x1	1x2.8/1x2.8	Behind the screen	Tack/Cable tie	4.4x2.5(200")	16.9			1	2 B
	E1-E4	35.8x18.7x3.6	617	306	624	290	6.8x1	1x2.8	Behind the screen	Tack/Cable tie	4.4x2.5(200")	16.9			Negotiable	Negotiable
	E5	18.7x18.7x3.6	350	162	320	120	6.8x1	1x2.8/1x2.8	Behind the screen	Tack/Cable tie	4.4x2.5(200")	16.9			2	2 B
	E6	18.7x17x3.6	318	144	288	120	6.8x1/6.8x1	1x2.8/1x2.8	Behind the screen	Tack/Cable tie	4.4x2.5(200")	16.9			2	2 B
	E5-E6	18.7x35.8x3.6	668	324	600	320	Negotiable	1x2.8/1x2.8	Behind the screen	Tack/Cable tie	4.4x2.5(200")	16.9			Negotiable	2 B
	E1-E6	44.8x35.8x3.6	1,604	810	1,232	780	Negotiable	1x2.8	Behind the screen	Tack/Cable tie	4.4x2.5(200")	16.9	Negotiable	Negotiable		
E7	9.1x14.7x3.5	134	75	140	60	6.8x1	1x2.8	Behind the screen	Tack/Cable tie	4.4x2.5(200")	16.9	5,000	-	1	1 C	
E8	5.1x8.9x3.3	46	24	40	20	4.5x1	1x2.6	Behind the screen	Tack/Cable tie	2.4x1.8(120")	4.3	Mobile 5,000	-	-	Upon request	

*All capacities subject to floorplan approval.

Venue	Dimensions W x L x H (m)	Area(m ²)	Capacity			Banner					Beam Projector			Stage(m) (Width x Length x Height)	Etc		
			CL	TH	BQ	Horizontal banner(m) (Width x Length)	Vertical banner(m) (Width x Length)	Banner (batten) Location	Banner display method	Screen (m) (Width x Length)	Screen ratio	Projector (Lumen)	Number of rentable wireless microphones		Type of podium		
3F Conference Room (South)	300	14x18x3.5	264	114	168	100	5.9x0.8	1x3.1	In front of the screen	Tack/Cable tie	4x3(200")	4:3	7,500 Built-in LED 5.5X 3	-	2	2 C	
	301A	7.3x12.7x3.3	104	54	100	50	6x0.8	1x2.7	In front of the screen	Tack/Cable tie	3x2.4(150")	4:3	Mobile 5,000	-	1	1 B	
	301B	12.7x9.7x3.3	103	54	100	30	5x0.8	1x2.7	In front of the screen	Tack/Cable tie	3x2.4(150")	4:3	6,200	8x3x0.2	1	1 B	
	301	12.7x17.9x3.3	207	99	164	90	5x0.8	1x2.7	In front of the screen	Tack/Cable tie	3x2.4(150")	4:3	6,200	-	2	2 B	
	302	3.8x9x3.1	40	20	40	20	350.7	1x2.5	-	-	PDP TV (70")	-	-	-	-	-	-
	303	3.9x9.5x3.1	40	20	40	20	350.7	1x2.5	-	-	PDP TV (70")	-	-	-	-	-	-
	304	6.2x9x3.1	54	24	48	20	3x0.7	1x2.5	In front of the screen	Magnet/Cable tie (requires ladder)	2.4x1.8(120")	4:3	Mobile 5,000	-	-	Upon request	
	305	6.2x9x3.1	54	24	48	20	3x0.7	1x2.5	In front of the screen	Magnet/Cable tie (requires ladder)	2.4x1.8(120")	4:3	Mobile 5,000	-	-	-	-
	306	3.8x9x3.1	40	20	40	20	-	-	-	-	PDP TV (70")	-	-	-	-	-	-
	307A	8x12.9x3.3	104	54	100	50	6x0.8	1x2.7	In front of the screen	Tack/Cable tie	3x2.25(150")	4:3	Mobile 5,000	-	-	-	-
	307B	10x12.9x3.3	104	54	100	50	6x0.8	1x2.7	In front of the screen	Tack/Cable tie	3x2.25(150")	4:3	Mobile 5,000	-	-	2	2 B
	307C	12.9x8.5x3.3	103	48	100	30	5x1	1x2.7	Behind the screen	Tack/Cable tie	3x2.4(150")	4:3	6,200	8x3x0.2	-	-	-
	307	12.9x26.8x3.3	311	156	300	120	5x1	1x2.7	Behind the screen	Tack/Cable tie	3x2.4(150")	4:3	6,200	8x3x0.2	-	-	-
	308A	8x12.9x3.3	104	54	100	50	6x0.8	1x2.7	In front of the screen	Tack/Cable tie	3x2.25(150")	4:3	Mobile 5,000	-	-	-	-
	308B	10x12.9x3.3	104	54	100	50	6x0.8	1x2.7	In front of the screen	Tack/Cable tie	3x2.25(150")	4:3	Mobile 5,000	-	-	2	2 B
	308C	12.9x8.5x3.3	103	48	100	30	5x1	1x2.7	Behind the screen	Tack/Cable tie	3x2.4(150")	4:3	6,200	8x3x0.2	-	-	-
	308	12.9x26.8x3.3	311	156	300	120	5x1	1x2.7	Behind the screen	Tack/Cable tie	3x2.4(150")	4:3	6,200	8x3x0.2	-	-	-
	309	3.9x9.5x3.1	40	20	40	20	-	-	-	-	PDP TV (70")	-	-	-	-	-	-
	310	6.2x9x3.1	54	24	48	20	4x1	1x2.5	In front of the screen	Magnet/Cable tie (requires ladder)	2.4x1.8(120")	4:3	Mobile 5,000	-	-	-	-
	311	6.2x9x3.1	54	24	48	20	4x1	1x2.5	In front of the screen	Magnet/Cable tie (requires ladder)	2.4x1.8(120")	4:3	Mobile 5,000	-	-	-	-
	312	3.8x9x3.1	40	20	40	20	-	-	-	-	PDP TV (70")	-	-	-	-	-	-
	313	3.9x9.5x3.1	40	20	40	20	-	-	-	-	PDP TV (70")	-	-	-	-	-	Upon request
	314	6.2x9x3.1	54	24	48	20	4x1	1x2.5	In front of the screen	Magnet/Cable tie (requires ladder)	2.4x1.8(120")	4:3	Mobile 5,000	-	-	-	-
	315	6.2x9x3.1	54	24	48	20	4x1	1x2.5	In front of the screen	Magnet/Cable tie (requires ladder)	2.4x1.8(120")	4:3	Mobile 5,000	-	-	-	-
	316	3.8x9x3.1	40	20	40	20	-	-	-	-	PDP TV (70")	-	-	-	-	-	-
	317A	8x12.9x3.3	104	54	100	50	6x0.8	1x2.7	In front of the screen	Tack/Cable tie	3x2.25(150")	4:3	Mobile 5,000	-	-	-	-
	317B	10x12.9x3.3	104	54	100	50	6x0.8	1x2.7	In front of the screen	Tack/Cable tie	3x2.25(150")	4:3	Mobile 5,000	-	-	2	2 B
	317C	12.9x8.5x3.3	103	48	100	30	5x1	1x2.7	Behind the screen	Tack/Cable tie	3x2.4(150")	4:3	6,200	8x3x0.2	-	-	-
	317	12.9x26.8x3.3	311	156	300	120	5x1	1x2.7	Behind the screen	Tack/Cable tie	3x2.4(150")	4:3	6,200	8x3x0.2	-	-	-
	318A	8x12.9x3.3	104	54	100	50	6x0.8	1x2.7	In front of the screen	Tack/Cable tie	3x2.25(150")	4:3	Mobile 5,000	-	-	-	-
	318B	10x12.9x3.3	104	54	100	50	6x0.8	1x2.7	In front of the screen	Tack/Cable tie	3x2.25(150")	4:3	Mobile 5,000	-	-	2	2 B
	318C	12.9x8.5x3.3	103	48	100	30	5x1	1x2.7	Behind the screen	Tack/Cable tie	3x2.4(150")	4:3	6,200	8x3x0.2	-	-	-
318	12.9x26.8x3.3	311	156	300	120	5x1	1x2.7	Behind the screen	Tack/Cable tie	3x2.4(150")	4:3	6,200	8x3x0.2	-	-	-	
319	3.9x9.5x3.1	40	20	40	20	-	-	-	-	PDP TV (70")	-	-	-	-	-	-	
320	6.2x9x3.1	54	24	48	20	4x1	1x2.5	In front of the screen	Magnet/Cable tie (requires ladder)	2.4x1.8(120")	4:3	Mobile 5,000	-	-	-	-	
321	6.2x9x3.1	54	24	48	20	4x1	1x2.5	In front of the screen	Magnet/Cable tie (requires ladder)	2.4x1.8(120")	4:3	Mobile 5,000	-	-	-	-	
322	3.8x9x3.1	40	20	40	20	-	-	-	-	PDP TV (70")	-	-	-	-	-	-	
323	3.9x9.5x3.1	40	20	40	20	-	-	-	-	PDP TV (70")	-	-	-	-	-	Upon request	
324	6.2x9x3.1	54	24	48	20	4x1	1x2.5	In front of the screen	Magnet/Cable tie (requires ladder)	2.4x1.8(120")	4:3	Mobile 5,000	-	-	-	-	
325	6.2x9x3.1	54	24	48	20	4x1	1x2.5	In front of the screen	Magnet/Cable tie (requires ladder)	2.4x1.8(120")	4:3	Mobile 5,000	-	-	-	-	
326	3.8x9x3.1	40	20	40	20	-	-	-	-	PDP TV (70")	-	-	-	-	-	-	
327A	8x12.9x3.3	104	54	100	50	6x0.8	1x2.7	In front of the screen	Tack/Cable tie	3x2.25(150")	4:3	Mobile 5,000	-	-	-	-	
327B	10x12.9x3.3	104	54	100	50	6x0.8	1x2.7	In front of the screen	Tack/Cable tie	3x2.25(150")	4:3	Mobile 5,000	-	-	2	2 B	
327C	12.9x8.5x3.3	103	48	100	30	5x1	1x2.7	Behind the screen	Tack/Cable tie	3x2.4(150")	4:3	6,200	8x3x0.2	-	-	-	
327	12.9x26.8x3.3	311	156	300	120	5x1	1x2.7	Behind the screen	Tack/Cable tie	3x2.4(150")	4:3	6,200	8x3x0.2	-	-	-	
328	6.6x13.9x2.9	96	42	80	50	5x0.8	1x2.2	Behind the screen	Cable tie	3x2.25(150")	4:3	5,000/Built-In LED 4x2.3(190")	-	2	1 C		
4F Conference Room (South)	400	5.6x13.8x3.4	78	(Fixed Type) BD	20	4.5x1	0.7x2.4	Behind the screen	Tack/Cable tie	3.3x1.85(150")	16:9	5,000	-	2	1 B		
	401	16x34x7	489	(Fixed Type) TH	441	12x1.5	1.5x5		Negotiable			-	13x9.4x0.8	2	2 A / 2 C		
	402	16.9x16.5x3.4	324	168	312	160	6.9x1	1x3	Behind the screen	Fixing clip/Cable tie	3.5x2.6(170")	4:3	6,200	11x3x0.2	2	2 C	
	403	8x16x3.2	144	72	140	60	6x1	1x3	Behind the screen	Tack/Cable tie	3x2.25(150")	4:3	5,000	6x2.5x0.2	2	2 C	
Grand Total			11,917	4,384	8,074	4,281											

※ All capacities subject to floorplan approval.

Capacity Summary

EXHIBITION HALLS

Venue		Dimensions		Ceiling Height		Usable Area		Capacities		
		Meters	Feet	Meters	Feet	Sq.Meters	Sq.Ft	CL	TH	BQ
Hall A		144.0 x 72.0	472.4 x 236.2	7.5 / 9.0	24.6 / 29.5	10,368	111,600			
Hall B	B1	45.0 x 81.0	1476 x 265.7	9.5	31.2	3,645	39,235			
	B2	45.0 x 81.0	1476 x 265.7	9.5	31.2	3,645	39,235			
	B1+B2	90.0 x 81.0	295.3 x 265.7	9.5	31.2	7,290	78,470			
	Swing Space	18.0 x 40.0	59.1 x 131.2	6.2	20.3	720	7,750			
Hall C	C1	36.0 x 72.0	118.1 x 236.2	8	26.3	2,572	27,900			
	C2	36.0 x 72.0	118.1 x 236.2	12.3	40.4	2,592	27,900			
	C3	36.0 x 72.0	118.1 x 236.2	12.3	40.4	2,592	27,900			
	C4	36.0 x 72.0	118.1 x 236.2	8	26.3	2,592	27,900			
	C1+C2+C3+C4	144.0 x 72.0	472.4 x 236.2	-	-	10,348	111,600			
Hall D	D1	36.0 x 81.0	118.1 x 265.7	17.5	57.4	2,916	31,388	1,600	3,200	1,600
	D2	45.0 x 81.0	1476 x 265.7	17.5	57.4	3,645	39,235	1,900	3,800	1,900
	D1+D2	81.0 x 81.0	265.7 x 265.7	17.5	57.4	6,561	70,623	3,500	7,000	3,500
	Swing Space	18.0 x 40.0	59.1 x 131.2	9.3	30.5	720	7,750			

Coex Venue Guide

513 Yeongdong-daero, Gangnam-gu,
Seoul, 06164, Korea
TEL +82-2-6000-1122, 1123
FAX +82-2-6944-8374
www.coexcenter.com

